

TM 9-1005-210-35

 DEPARTMENT OF THE ARMY TECHNICAL MANUAL

DS, GS, AND DEPOT MAINTENANCE MANUAL
INCLUDING REPAIR PARTS AND SPECIAL
TOOLS LISTS

CARBINE, CALIBER .30, M1, W/E
(1005-670-7670)

 CARBINE, CALIBER .30, M2, W/E
(1005-670-7675)



 HEADQUARTERS, DEPARTMENT OF THE ARMY



JUNE 1969



WARNING

DANGEROUS PROCEDURE

Before starting an inspection be sure to clear weapon. Do not actuate trigger until weapon has been cleared. Inspect chamber to insure that it is empty, and check to see that no ammunition is in position to be introduced.



TECHNICAL MANUAL

No. 9-1005-210-35

HEADQUARTERS,
DEPARTMENT OF THE ARMY
WASHINGTON, D. C., 10 June 1969

DS, GS, AND DEPOT MAINTENANCE MANUAL INCLUDING REPAIR PARTS

AND SPECIAL TOOLS LISTS

CARBINE, CALIBER .30, M1, W/E

(1005-670-7670)

CARBINE, CALIBER .30, M2, W/E

(1005-670-7675)

This manual is current as of 27 May 1969

	Paragraphs	Pages
CHAPTER 1. INTRODUCTION		
Section I. General	1-1, 1-2	8
II. Description and data	1-3, 1-4	8
CHAPTER 2. DIRECT SUPPORT, GENERAL SUPPORT, AND DEPOT MAINTENANCE INSTRUCTIONS		
Section I. Repair parts, special tools and equipment	2-1	5
II. Troubleshooting	2-2	5
III. Preembarkation inspection of materiel in units alerted for overseas movement	2-3, 2-4	6, 7
IV. General maintenance	2-5-2-7	7
V. Depot maintenance instructions	2-8	7
CHAPTER 3. REPAIR INSTRUCTIONS	3-1-3-6	9-20
CHAPTER 4. MAINTENANCE OF MATERIEL USED IN CONJUNCTION WITH MAJOR ITEM	4-1, 4-2	28
CHAPTER 5. FINAL INSPECTION	5-1-5-3	25
APPENDIX A. REFERENCES		27
APPENDIX B. DIRECT SUPPORT, GENERAL SUPPORT, AND DEPOT MAINTENANCE REPAIR PARTS AND SPECIAL TOOLS LIST		
Section I. Introduction	B-1-B-7	29-31
II. Repair Parts List		82
Repair Parts For:		
Major groups, assemblies and components (Fig B1)		44
Stock group (Fig B2)		45
Trigger housing assembly (Fig B3)		45
Bolt assembly (Fig B4)		45
Barrel and receiver group (Fig B5)		46
Oiler (Fig B6)		46
SECTION III. Special Tools, Test and Support Equipment		39
Tools and equipment authorized for unit replacement (Figs B7 and B8)		47
Tools and equipment (Fig B9)		48
IV. Federal Stock Number and Reference Number Cross Reference to Figure and Item Number		49

*This manual supersedes TM 9-1005-210-35P, 17 October 1968, including changes, in its entirety and TM 9-1276, 17 February 1958, including changes, in its entirety.



CHAPTER 1

INTRODUCTION

Section I. GENERAL

1-1. Scope

These instructions are in accordance with the maintenance allocation chart and are published for the use of direct and general support and depot maintenance personnel maintaining the Caliber .30 Carbines, M1 and M2.

1-2. Forms and Records

a. General. Maintenance forms, records, and reports which are to be used by maintenance personnel at all maintenance levels are listed in and prescribed by TM 38-750.

b. Recommendations for Maintenance Manual Improvements. Report of errors, omissions, and recommendations for improving this publication by the individual user is encouraged. Reports should be submitted on DA Form 2028, Recommended Changes to DA Publications, and forwarded direct to:

Commanding General
Headquarters
U. S. Army Weapons Command
ATTN: AMSWE-SMM-P
Rock Island, Illinois 61201

Section II. DESCRIPTION AND DATA

1-3. Description

Refer to TM 9-1005-210-12 for description of the carbines. See figures 1-1 and 1-2 for overall views.

1-4. Tabulated Data

Refer to TM 9-1005-210-12.



Figure 1-1. Caliber .30 Carbine M1—right rear view.

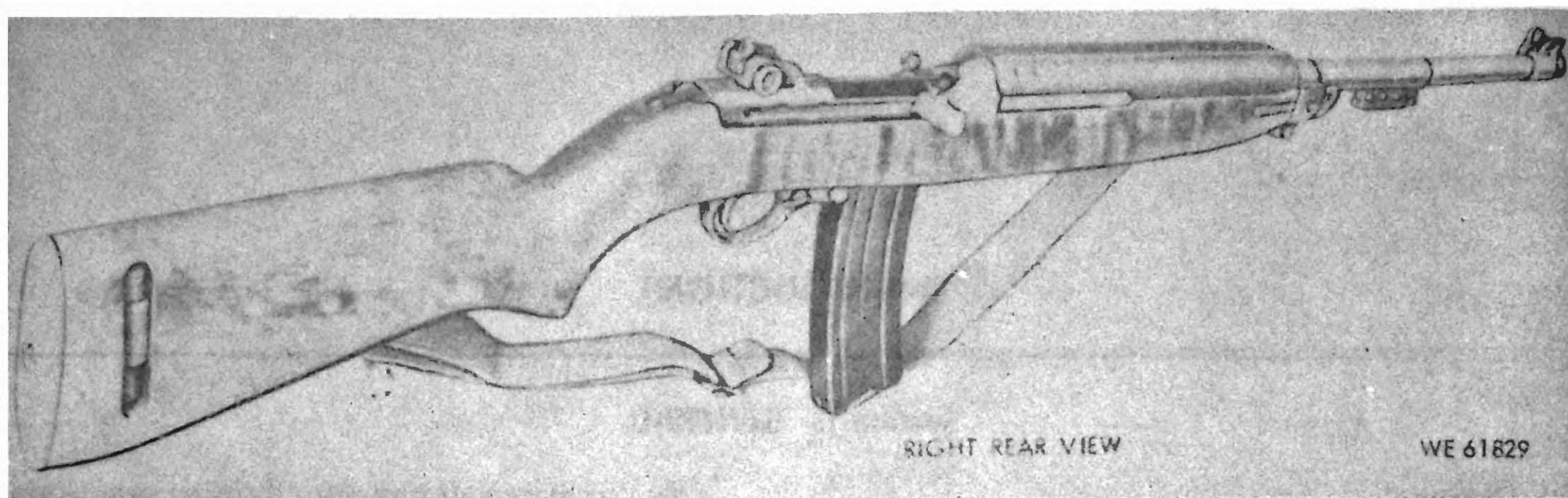

Figure 1-2. Caliber .30 Carbine M2—right rear view.

CHAPTER 2

DIRECT SUPPORT, GENERAL SUPPORT, AND DEPOT MAINTENANCE INSTRUCTIONS

Section I. REPAIR PARTS, SPECIAL TOOLS AND EQUIPMENT

2-1. General

a. Repair parts, special tools, test, and support equipment are listed in appendix B.

b. Refer to table 2-1 for usage of the special tools and equipment.

Table 2-1. Special Tools and Equipment

Item	Reference no.	Reference		Use
		Fig no.	Para no.	
Bolt, field test	7319932	3-10	3-4	Used with headspace gage to determine whether chamber, bolt, or bolt lug seats in the receiver are worn.
Gage, headspace 1.302	7319943	3-10	3-4	To check distance between base of cartridge and face of bolt assembly.
Tool, assembling, adjustable, rear sight:	7312068	3-4 and 3-5		To remove/install adjustable rear sight from carbine.
Tool assembly, bolt, carbine: assembling and disassembling	7313298		3-2	To disassemble/assemble bolt assembly.
Tool, assembling, front sight	7161313	3-2		To aline and install front sight to carbine.
Tool, gas cylinder, reconditioning:	7160995	3-3 and 3-9		To remove/install gas cylinder piston nut and to recondition threads in gas cylinder.
Tool, removing, front sight:	7161237	3-4		To remove front sight from barrel.
Tool, removing, trigger spring:	7160026		3-2	To remove/install trigger spring from trigger housing.
Wrench, spanner: gas piston nut	5621065		3-2	To remove/install gas cylinder piston nut.
Wrench, torque:	Ggg w 686	3-5	3-2e. (5)	Used in conjunction with rear sight assembling tool to measure pressure required to position adjustable rear sight.

Section II. TROUBLESHOOTING

2-2. General

Refer to TM 9-1005-210-12 for troubleshooting pertinent to operator and organiza-

tion maintenance. Refer to table 2-2 for troubleshooting pertinent to direct and general support maintenance.

Table 2-2. Troubleshooting

Malfunction	Probable cause	Corrective action
1. Failure to feed	a. Binding or damaged operating slide	a. Repair or replace
2. Failure to chamber	b. Defective magazine	b. Replace magazine
	a. Damaged operating slide	a. Replace
	b. Insufficient headspace	b. Replace bolt or evacuate to depot maintenance
	c. Roughness on camming surfaces or bolt lugs	c. Repair/replace bolt
3. Failure to lock	d. Chamber rough or pitted	d. Evacuate to depot maintenance
	a. Insufficient headspace	a. Replace bolt or evacuate to depot maintenance
4. Failure to unlock	b. Burred or damaged locking lugs	b. Remove burs or replace bolt
	a. Damaged gas piston	a. Replace
	b. Damaged operating slide	b. Replace
5. Failure to extract	Large pits in chamber	Evacuate to depot maintenance.
6. Failure to eject	Damaged bolt	Replace
7. Failure to cock	a. Damaged disconnecter	a. Replace
	b. Damaged sear	b. Replace
8. Short recoil	a. Unserviceable gas cylinder	a. Chase threads (fig 3-9)
	b. Gas cylinder piston	b. Replace
9. Trigger hand	Unserviceable trigger	Repair/replace
10. Trigger pull too light	a. Foreign matter or burs on hammer, sear, or trigger	a. Remove
	b. Unserviceable sear spring	b. Replace
	c. Uneven surfaces on hammer or sear	c. Repair or replace
11. Trigger pull too heavy	a. Foreign matter or burs on hammer, sear, or trigger	a. Remove
	b. Uneven surfaces on hammer or sear	b. Repair or replace
12. Creep in trigger	a. Damaged sear, hammer or trigger	a. Replace
	b. Obstruction in housing	b. Remove
13. Safety sticks	a. Unserviceable magazine catch retainer plunger assembly	Note. Do not deviate from original configuration. a. Repair/replace
	b. Damaged safety	b. Replace
14. Operating slide does not operate smoothly	Misalignment of barrel in receiver	Evacuate to depot maintenance
15. Pressure on trigger does not release hammer	a. Damaged trigger	a. Replace
	b. Frozen sear spring	b. Replace
	c. Broken hammer spring or plunger	c. Replace
	d. Missing sear spring	d. Replace
16. Disconnecter fails to function	Broken projecting lug on rear of disconnecter	
17. Operating slide does not remain in open position	a. Damaged operating slide stop	a. Replace
	b. Unserviceable operating slide stop spring	b. Replace

Section III. PREEMBARKATION INSPECTION OF MATERIEL IN UNITS ALERTED FOR OVERSEAS MOVEMENT

2-3. General

This section provides specific instructions for guidance during inspection by direct and general support personnel of materiel in

alerted units scheduled for oversea duty. Inspection is made for the purpose of:

- Determining serviceability.
- Recognizing conditions that would cause failure.

c. Assuring proper maintenance at prescribed levels.

d. Determining the ability of a unit to accomplish its maintenance and supply mission.

2-4. Inspection Procedures

Warning. Before starting an inspection, be sure to clear the weapon. DO NOT actuate the trigger until the weapon has been cleared. Inspect the chamber to insure that it is empty, and check to see that no ammunition is in position to be introduced.

a. Complete inspection of all parts is not always necessary; exercise judgment regarding degree of inspection of integral parts within assemblies.

b. Refer to TB 9-1000-247-35 and table 2-3 for inspection criteria.

Table 2-3. Preembarkation Inspection

Item	Inspection criteria
Safeties	Only rotary type safeties are acceptable.

Item	Inspection criteria
Magazine catches	Only those with the magazine supporting tang are acceptable.
Bolts	M2 Carbines must have full round bolts only.
Extractor	Shank of extractor must not protrude beyond the bolt body.
Headspace	Maximum 1.302 inches (use gage 7319943). <i>Note.</i> Disengage operating slide from bolt before checking headspace. Bolt assembly should not close under <i>light</i> finger pressure on bolt locking lug.
Trigger Pull	Minimum 4-1/2 pounds; maximum 7 pounds (use fixture 7274758).
Butt plate	Maximum overhang 1/32-inch.
Hand guard	M2 Carbine must have the four the rivet type only.
Selector	When M2 Carbine is set for automatic fire with trigger pulled back, hammer must fall when operating slide is pulled to rear and slowly released.

Section IV. GENERAL MAINTENANCE

2-5. General

a. Complete disassembly of a unit is not always necessary in order to make a required repair or replacement. Exercise good judgment to keep disassembly and assembly operations to a minimum.

b. Tool sets provided for maintenance of the carbines are listed in appendix B.

2-6. General Repair Methods

- a. Repair or replace all unserviceable parts.
 - (1) Replace pins, screws, nuts, and washers, if needed and available.
 - (2) Replace any springs that are broken, kinked, bent, cracked, fail to function properly, or fail to meet specific requirements.

(3) When a new part is not available a reconditioned part may be substituted. Examine reconditioned parts carefully to determine their serviceability.

b. Remove burs and rough edges with a file or stone.

c. For cleaning and lubricating instructions refer to TM 9-1005-210-12.

Note. Lubricate all sliding surfaces before assembly.

2-7. Refinishing Surfaces

- a. Restore finish to all shiny surfaces to match the appearance of new parts.
- b. If facilities to refinish are not available, black lusterless paint may be used.

Section V. DEPOT MAINTENANCE INSTRUCTIONS

2-8. General

a. Depot maintenance instructions are contained in USAWECOMDMWR 1005-210, which is available through Headquarters, U.S.

- Army Weapons Command, ATTN: AMS-WE-SMM-SA, Rock Island, Illinois 61201.
- b. Repair parts are listed in appendix B.



CHAPTER 3

REPAIR INSTRUCTIONS

3-1. Removal/Installation of Major Groups and Assemblies

Refer to TM 9-1005-210-12 and figure B-1.

3-2. Disassembly/Assembly of Major Groups and Assemblies

Note. Usage of tools 71313298, 7160026, and 5621065 is illustrated in TM 9-1005-210-12.

- a. *Magazine.* Refer to TM 9-1005-210-12.
- b. *Stock Group.* Refer to figure B-2.
- c. *Trigger Housing Group.* Refer to items 6 thru 11, figure B-1, and figure B-3.
- d. *Bolt Assembly.* Refer to figure B-4.
- e. *Barrel and Receiver Group.*
 - (1) *General.* Refer to figure B-5.
 - (2) *Front sight.* Refer to figures 3-1, 3-2 and B-5.

Note. Front sight key must be staked at rear end of keyway in barrel. Exercise care in staking to prevent distortion of barrel. Body of front sight must be crimped over both ends of front sight pin.

- (3) *Retaining band.* Refer to item 5, figure B-5.

Note. Front band screw must be spun to prevent loss.

- (4) *Gas cylinder piston nut.* Refer to figure 3-3.

Note. Nut must be *lightly* staked with sharp center punch in one of three places provided.

- (5) *Rear sight.* Refer to figures 3-4 and 3-5.

Note. Torque during installation should show a reading of between 18 and 54 pounds. Take reading during movement of wrench as reading taken when starting wrench will be high and not accurate. If torque during movement is less than 18 pounds, peen dovetail slot of receiver slightly as shown in figure 3-6. If torque is more than 54 pounds during movement, file base of rear sight slightly as shown in figure 3-7. When properly installed, stake sight in places indicated in figure 3-8. Exercise care to prevent cracking of dovetail slot on receiver.

3-3. Cleaning, Lubrication, Inspection and Repair

- a. *Cleaning and Lubrication.* Refer to TM 9-1005-210-12.

- b. *Inspection and Repair.* Refer to table 3-1.

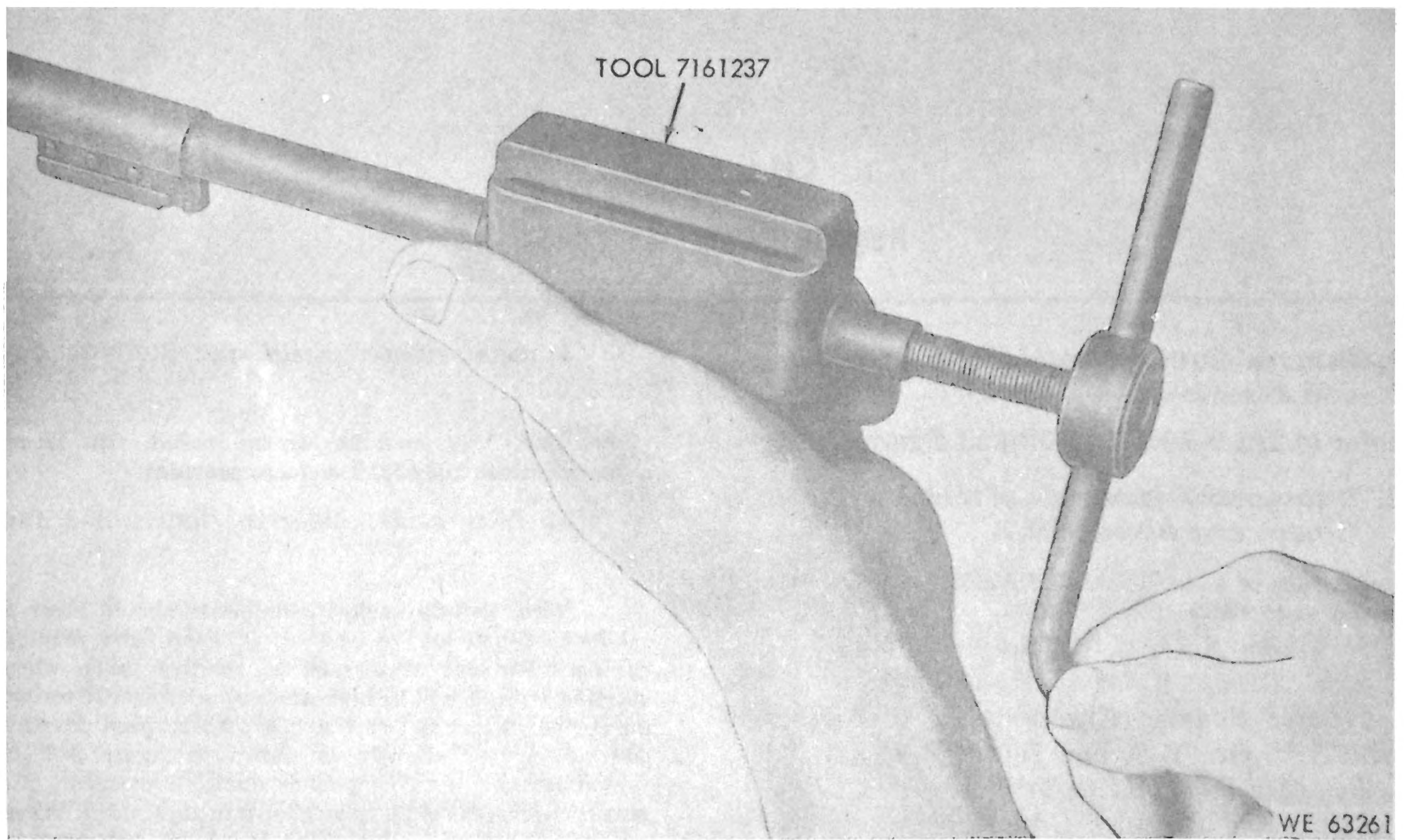

Figure 3-1. Removing front sight using tool 7161237.

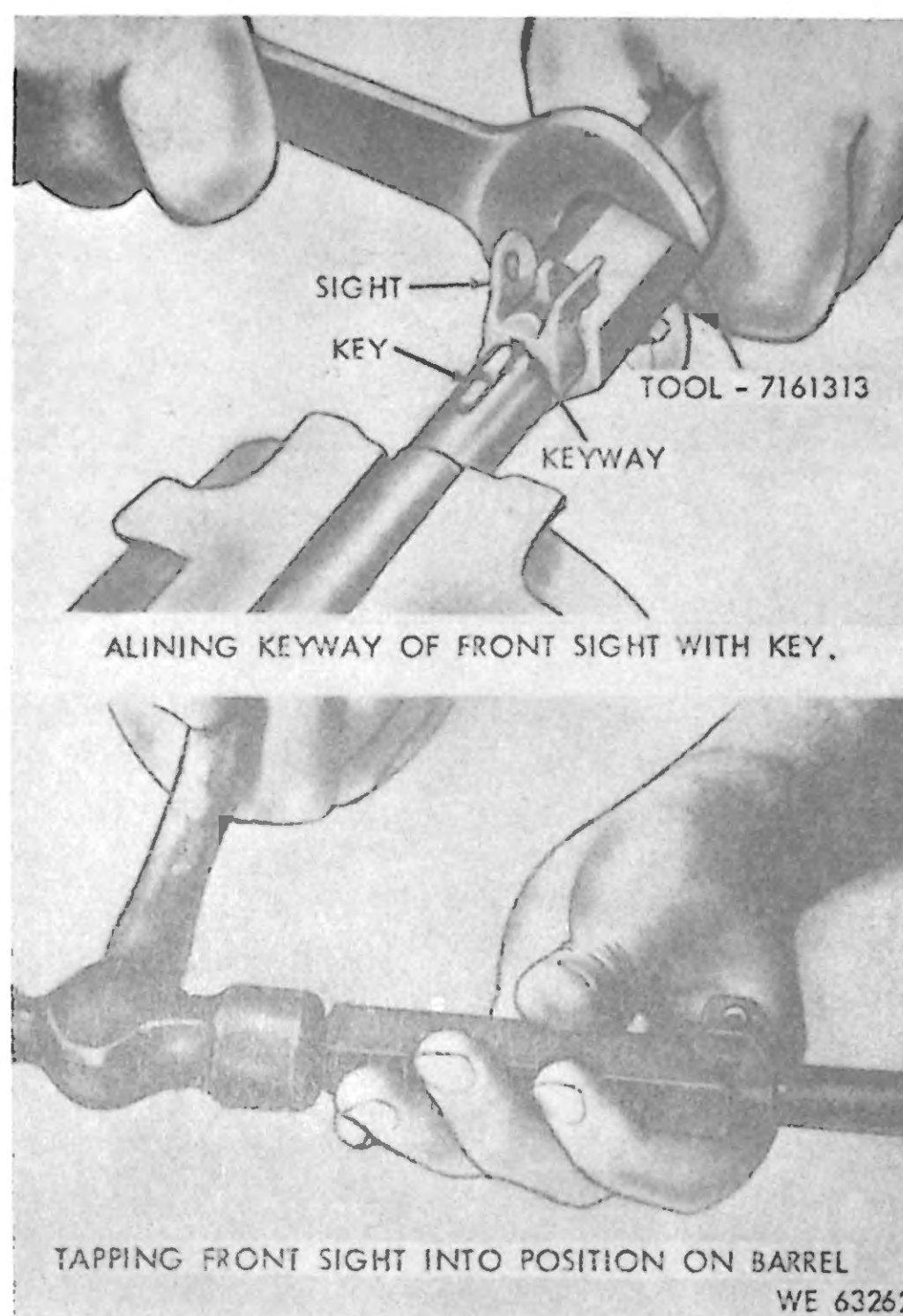

Figure 3-2. Installing front sight, using tool 7161313.

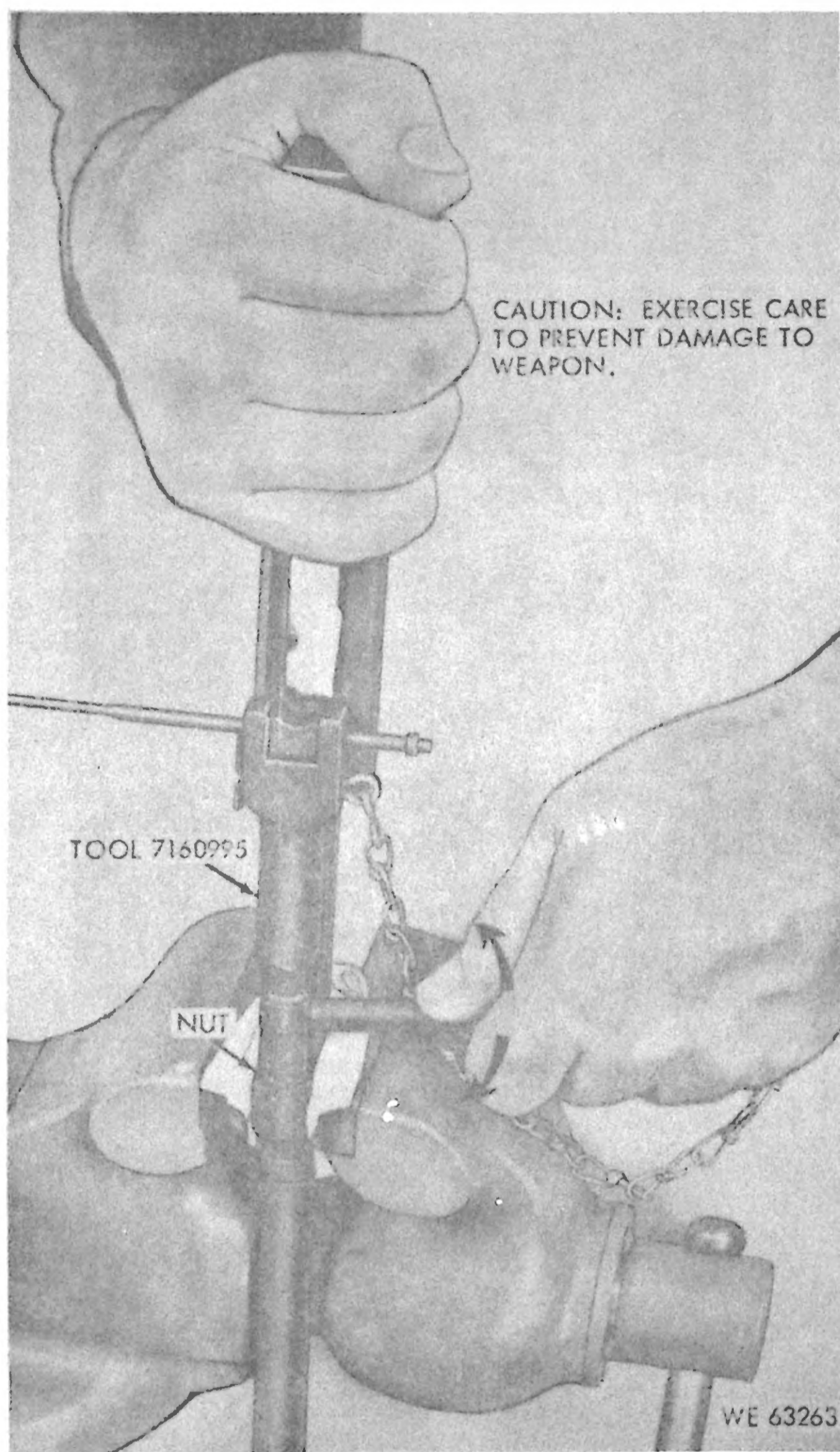

Figure 3-3. Removing and installing gas cylinder piston nut, using tool 7160995.

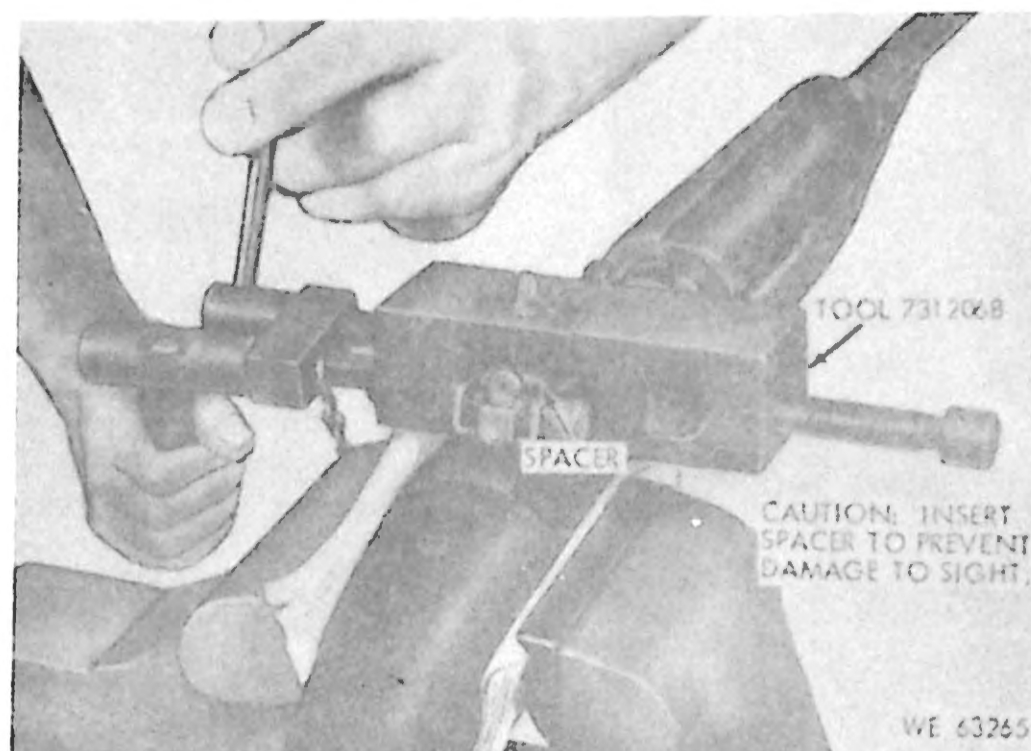

Figure 3-4. Removing rear sight, using tool 7312068.

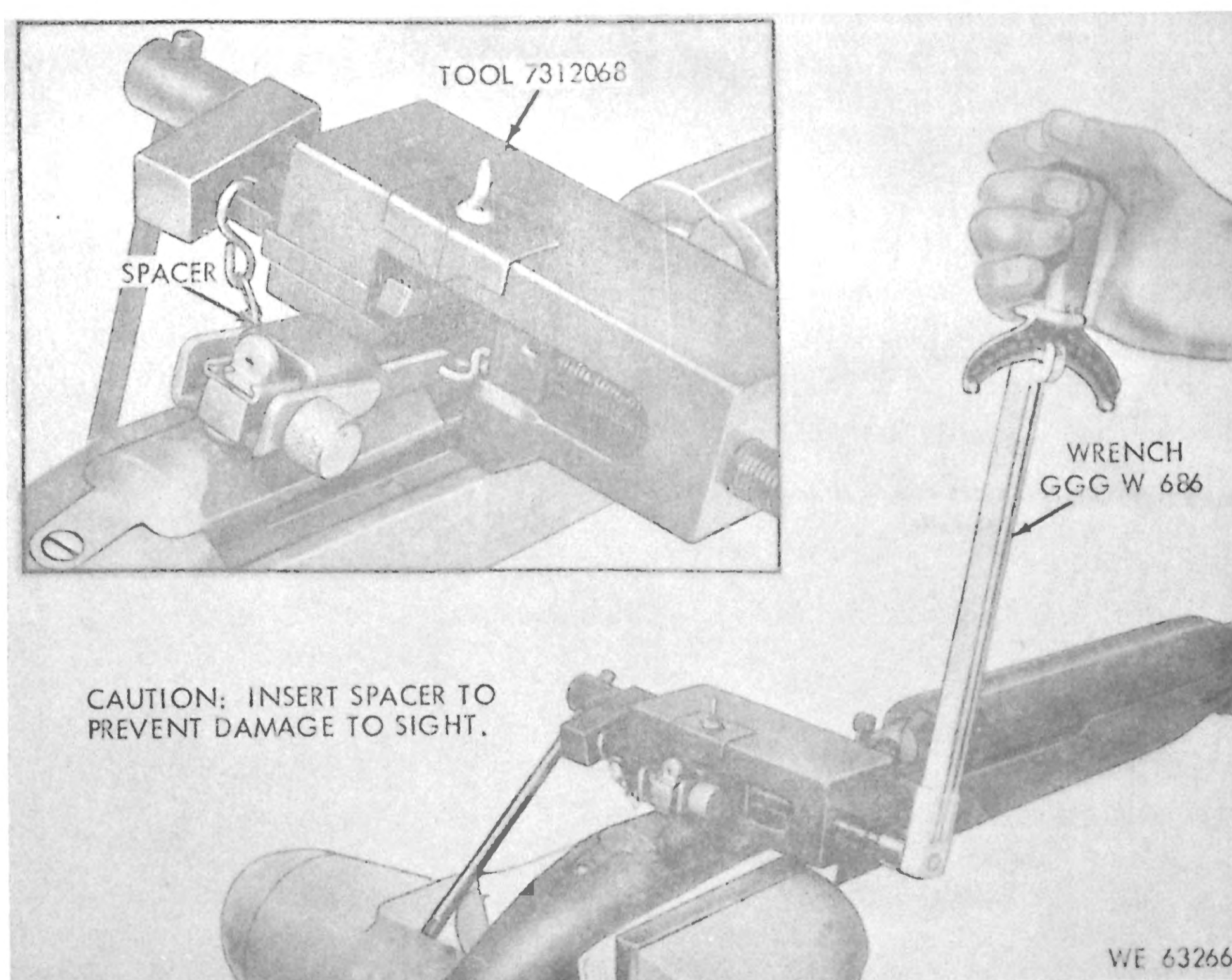

Figure 3-5. Installing rear sight, using tool 7312068 and torque wrench GGG W 686.

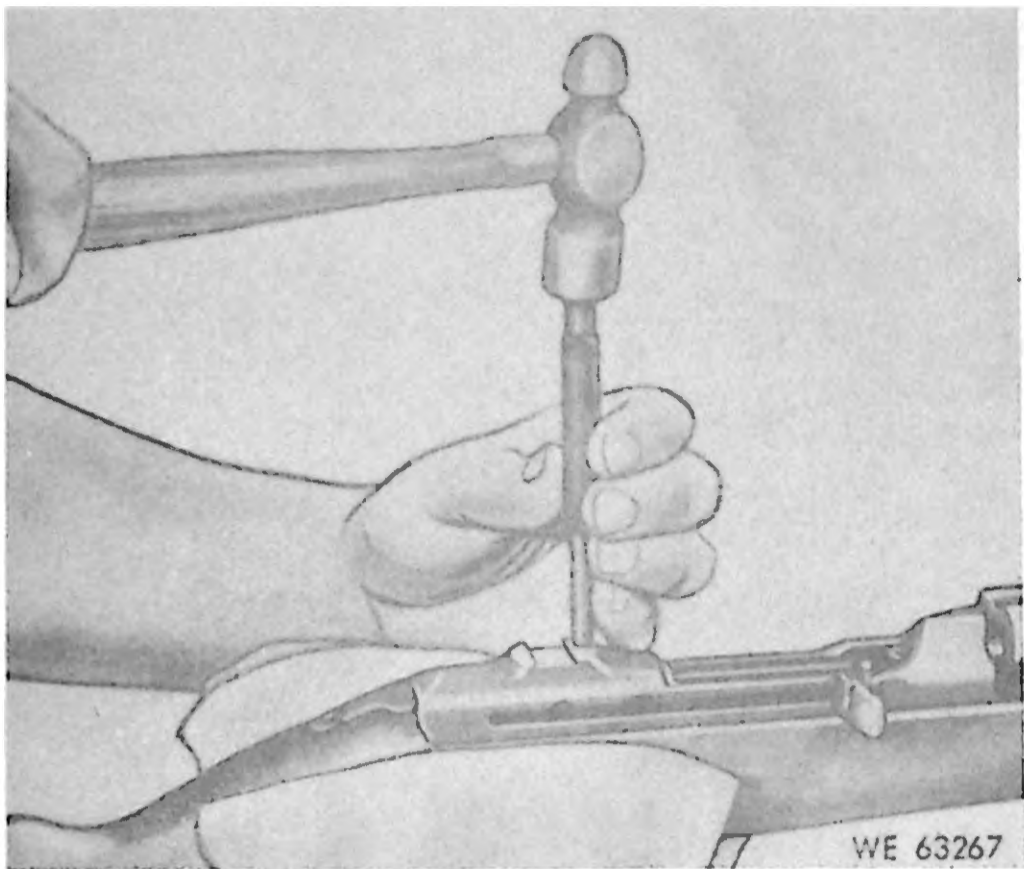

Figure 3-6. Peening receiver to reduce oversize dovetail slot.

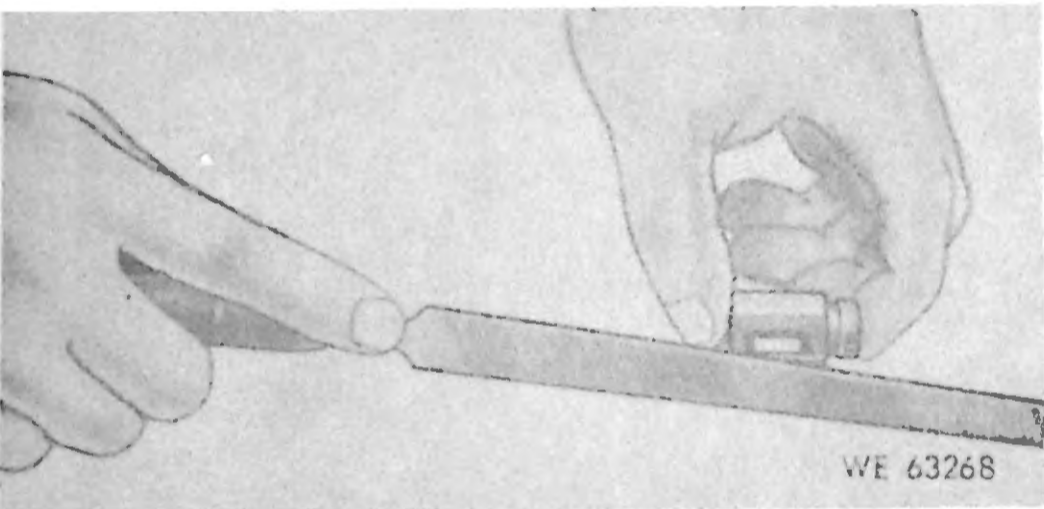

Figure 3-7. Filing rear sight base to fit undersize dovetail slot.

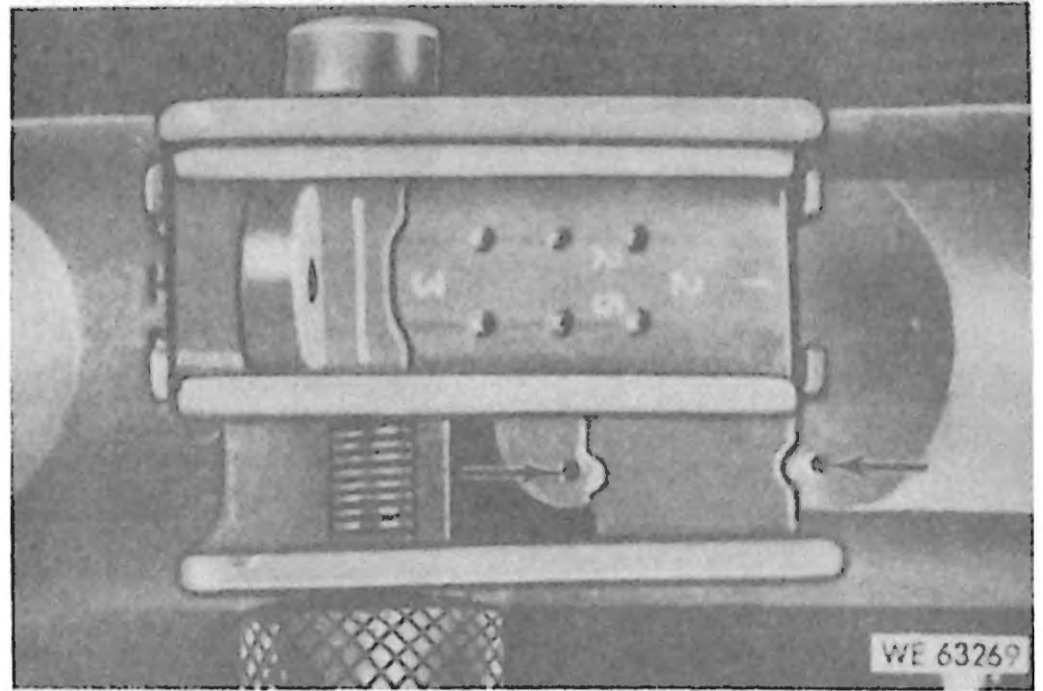

Figure 3-8. Rear sight showing staking.

Table 3-1. Repair of Carbines

Item	Inspection	Repair
	<p>Warning. Before starting an inspection be sure to clear weapon. Do not actuate trigger until weapon has been cleared. Inspect chamber to insure that it is empty, and check to see that no ammunition is in position to be introduced.</p>	
General	<p>Inspect exterior for general overall appearance.</p> <p>Inspect all components for burs, rust, corrosion or foreign matter.</p>	<p>Refer to para 2-5 thru 2-7 for general repair instructions.</p> <p>Remove burs, rust, corrosion, or foreign matter from all components.</p>
Magazine	<p>Inspect components for damage. Inspect spring for tension. Inspect follower for smooth movement in tube when depressed. Inspect base for secure retention in magazine.</p>	<p>Replace magazine, if needed.</p>
Hand guard	<p>Inspect for cracks affecting strength.</p> <p>Inspect to insure that only the four-rivet type hand guard is used on the M2 Carbine.</p>	<p>Replace hand guard, if needed.</p> <p>Refer to TM 9-1005-301-30 for repair.</p>
Stock group	<p>Inspect liner for secure installation.</p> <p>Inspect for cracks affecting strength.</p> <p>Inspect butt plate and screw for secure installation. Threads must not be stripped.</p> <p>Inspect butt plate for overhang. Maximum overhang is 1/32 inch.</p> <p>Inspect locking spring for retention of band.</p> <p>Inspect recoil plate and screw for secure installation. Recoil plate must be properly bedded in stock.</p>	<p>Replace items 1 thru 4, fig B-2, as needed.</p> <p>Refer to TM 9-1005-301-30 for repair of stock.</p>
Trigger housing group	<p>Inspect oiler recess for unsightly chipping.</p> <p>Inspect for missing or unserviceable components.</p> <p>Inspect selector spring for deformation. Spring must hold selector in desired position.</p> <p>Inspect disconnecter pin slot in selector for damage.</p> <p>Inspect disconnecter lever for distortion, freedom of movement on its pivot, and ends for proper alignment. Rivet must be secure.</p>	<p>Replace items 6, 7, 8, and 10, fig B-1 and items 1 thru 16, fig B-3 as needed.</p>

Item	Inspection	Repair
Trigger housing Group— Continued	<p>Inspect hammer spring plunger for proper seating in hammer.</p> <p>Inspect hammer spring for weakness or deformation.</p> <p>Inspect hammer for chips or cracks. Any evidence that sear notch has been stoned is cause for rejection. Hammer must remain to rear when in cocked position.</p> <p>Inspect projecting lug on rear of disconnecter for cracks or damage.</p> <p>Inspect disconnecter plunger and spring for deformation or damage.</p> <p>Inspect trigger spring for deformation. Check for proper seating. Tips of spring should be slightly spread.</p> <p>Inspect trigger for smooth function. Trigger must return to forward position under spring tension when released. Trigger must not have tendency to stick or hang.</p> <p>Inspect sear for movement on trigger pin. Sear must move under light pressure and return to original position under spring tension when released.</p> <p>Inspect sear spring for serviceability.</p> <p>Inspect magazine catch for proper function. Catch must move under finger pressure and return to original position under spring tension. Catch must retain magazine securely. Only those magazine catches with magazine supporting tang are acceptable.</p> <p>Inspect magazine catch plunger assembly and magazine catch retainer plunger assembly for deformation.</p> <p>Inspect safety for smooth rotation and retention in desired position. Only rotary type safeties are acceptable. When in safe position, safety must prevent trigger from being actuated.</p> <p>Inspect T-lug on trigger housing for cracks.</p>	

Table 3-1. Repair of Carbines—Continued

Item	Inspection	Repair
Operating slide group	<p>Inspect operating slide spring guide for damage. Front tip of guide must seat positively in well of operating slide.</p> <p>Inspect operating slide spring for deformation or weakness.</p> <p><i>Note.</i> Operating slide spring must have free length of not less than 10 inches and not more than 10-3/4 inches.</p> <p>Inspect operating slide for damaged guide lugs, bolt camming lug and recess, and operating slide spring guide well.</p> <p>Inspect operating slide stop and spring for damage. When assembled, stop and spring must depress under finger pressure and return when released.</p>	<p>Replace items 4, 5, 12, 13, and 14, fig B-1, as needed.</p>
Bolt assembly and Barrel and receiver group	<p>Check headspace in accordance with para 3-4.</p>	
Bolt assembly	<p>Inspect assembled bolt to insure extractor shank does not protrude beyond body of bolt.</p> <p>Inspect extractor plunger and spring for deformation. Extractor and plunger must move under spring tension.</p> <p>Inspect ejector plunger and spring for deformation. Ejector must return forcibly when depressed. Ejector must not protrude beyond front face of bolt skirt (lip).</p> <p>Inspect firing pin for damage. Check point for proper contour.</p> <p>Check to assure firing pin does not bind within bolt.</p> <p>Inspect bolt for cracks, especially in area around right hand locking lug. Inspect cams for damage. Inspect firing pin hole for elongation.</p> <p>Check to assure only full round bolts 7160092 are used in M2 Carbines.</p>	<p>Replace items 1 thru 8 except 5, fig B-4 as needed.</p>
Barrel and receiver group	<p>Inspect components for damage.</p> <p>Inspect front sight for secure installation. Body of front sight must be crimped</p>	<p>Replace items 2 thru 6, 8, 9, and 11, fig B-5 as needed.</p>

Table 3-1. Repair of Carbines—Continued

Item	Inspection	Repair
<p>Barrel and receiver group— Continued</p>	<p>Inspect retaining band for freedom of movement on barrel. Inspect band and screw for stripped threads. Screw must be spun to prevent loss. Rivets must be secure.</p> <p>Inspect gas piston for freedom of movement in gas cylinder when barrel is tilted end for end.</p> <p>Inspect piston nut for secure installation. Nut must be lightly staked in one of three places provided.</p> <p>Inspect barrel for bulges, erosion, pits, or distortion. If bore contains small pits but has sharp and uniformly distinct lands, is free from bulges or other distortion, it is serviceable. Pits must not extend the width of a land or groove, and must not be 3/8 inch long or longer. Barrels must not have pits large enough to cause extraction difficulties.</p> <p>Inspect rear sight for secure installation. Receiver must be staked into sight in places provided (fig 3-8).</p> <p>Inspect sides of base for distortion.</p> <p>Inspect windage knob for proper operation. Knob must be free enough for hand operation, move with distinct clicks, and retain its setting.</p> <p>Inspect ramp for lateral movement. Ramp should move to extreme limit on either side without objectionable binding.</p> <p>Inspect aperture slide for proper function. Slide must be free enough for hand operation, move with distinct clicks, and be positively retained at each setting.</p> <p>Inspect T-slot, cams, slide rails, guideways, and lugs of receiver for cracks or deformation.</p> <p>Inspect serial number for legibility.</p>	<p>When necessary, chase threads as shown in figure 3-9.</p> <p>If sight is loose, tighten sight in accordance with procedures in paragraph 3-2e (5).</p>
Assembled carbine	Inspect for overall condition and general appearance. Hand operate to insure proper function and absence of binding.	

Table 3-1. Repair of Carbines—Continued

Item	Inspection	Repair
Assembled carbine— Continued	<p>Check to assure operating slide stop and spring positively retain bolt assembly and operating slide to rear.</p> <p>Inspect to assure bayonet stud positively retains bayonet.</p> <p>Check trigger pull in accordance with paragraph 8-5.</p>	

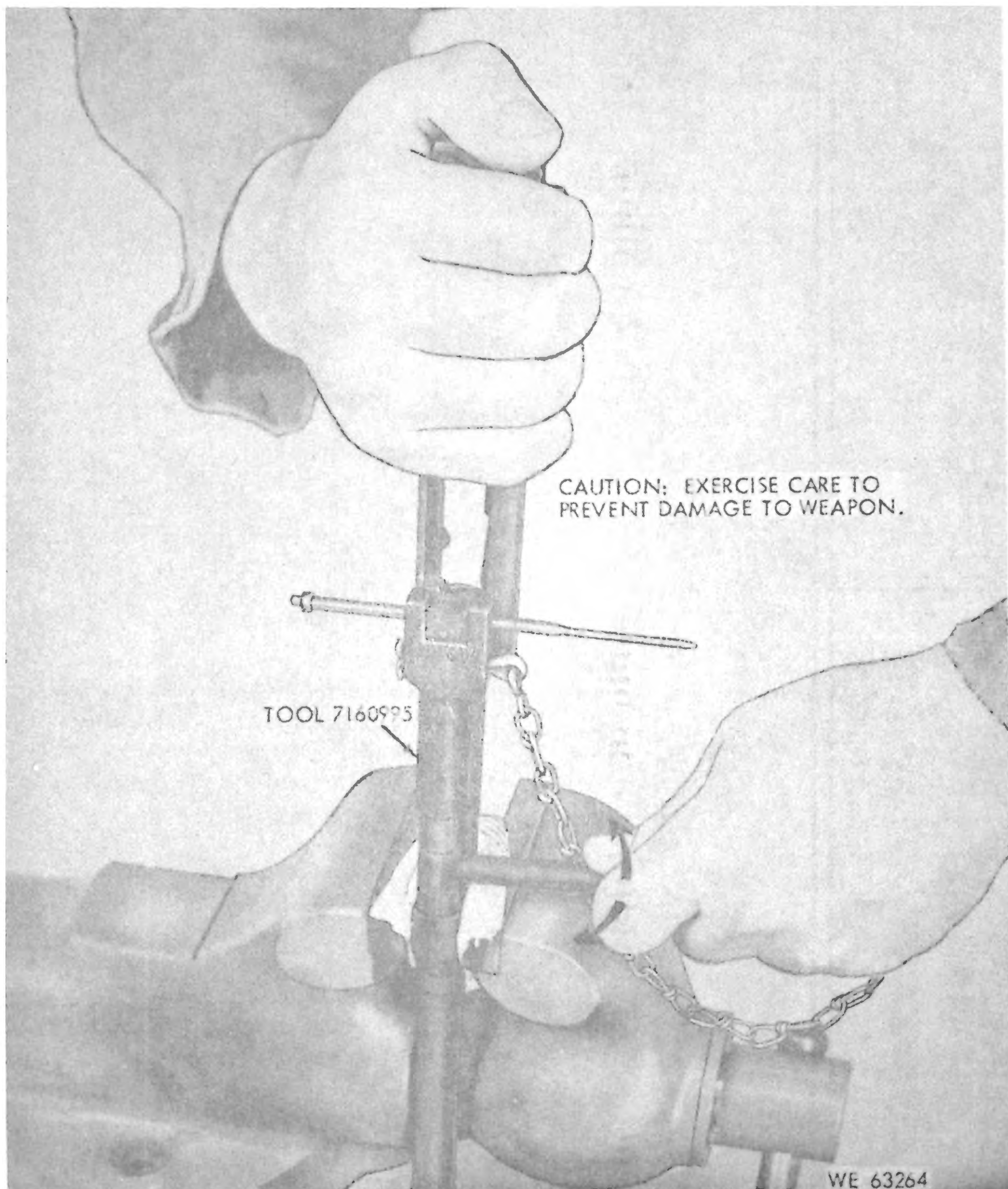

Figure 3-9. Chasing gas cylinder threads, using tool 7160995.

3-4. Checking Headspace

Note. Clean before checking headspace.

a. With operating slide disengaged, use gage 7319943 to check distance between base of cartridge and face of bolt assembly (fig. 3-10). Bolt assembly should not close under *light* finger pressure on bolt locking lug.

b. If bolt assembly closes on gage, headspace is excessive. Use field test bolt 7319932 to determine whether bolt, chamber or bolt lug seats in the receiver are worn. If field test bolt does not close on gage, bolt is worn and

must be replaced. If field test bolt does close on gage, barrel and receiver are unserviceable and will be rejected.

3-5. Checking Trigger Pull

Note. Cock weapon before checking trigger pull. Check trigger pull with trigger pull measuring fixture 7274758 (fig. 3-11). Trigger pull must be not less than 4-1/2 lb. and not more than 7 lb.

3-6. Correcting Trigger Pull

Refer to table 2-2.

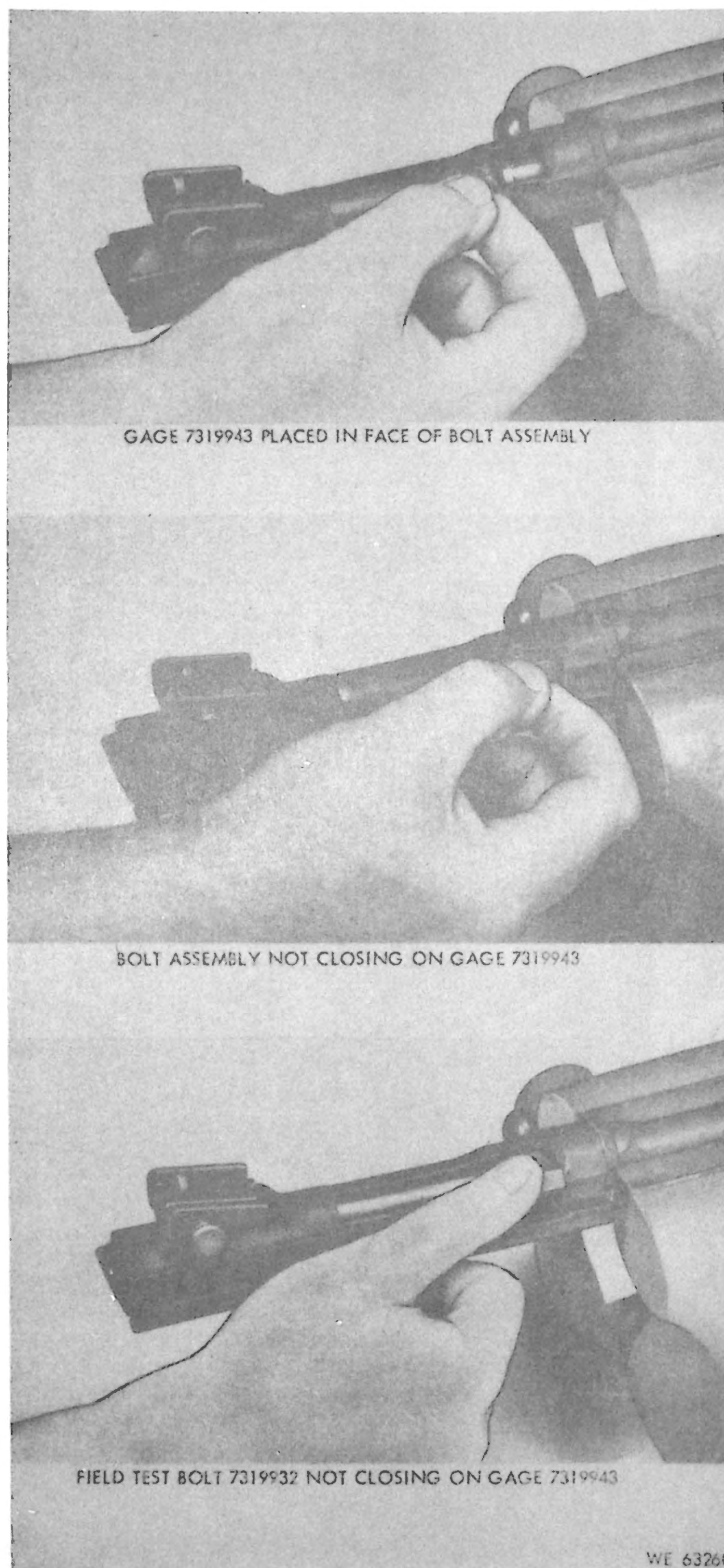

Figure 3-10. Checking headspace, using gage 7319943 and field test bolt 7319932.

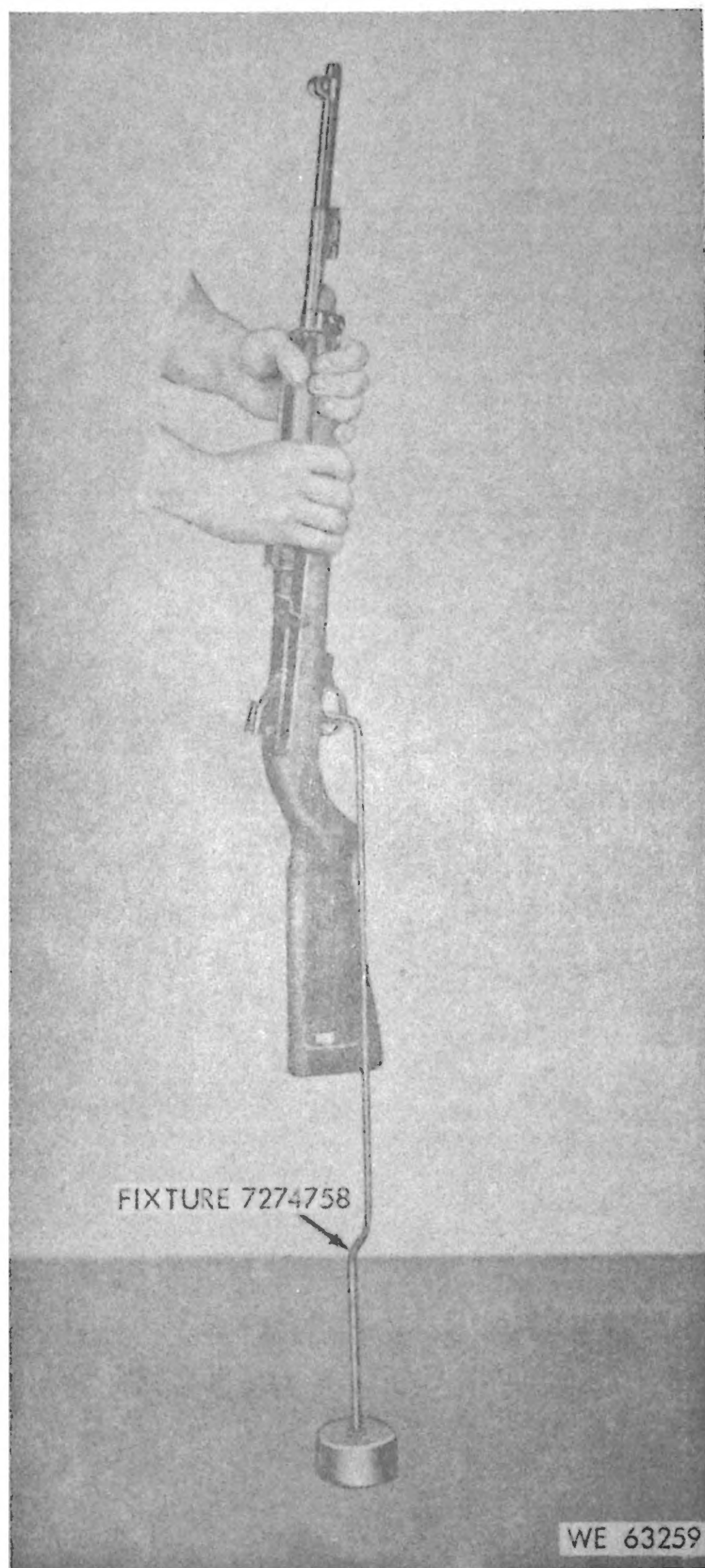

Figure 3-11. Checking trigger pull, using fixture 7274758.

CHAPTER 4

MAINTENANCE OF MATERIEL USED IN CONJUNCTION WITH MAJOR ITEM

4-1. Operation of Materiel Used in Conjunction with Major Item

Refer to TM 9-1005-210-12.

4-2. Maintenance of Materiel Used in Conjunction with Major Item

Refer to table 4-1.

Table 4-1. Maintenance of Materiel Used in Conjunction With Major Item

Item	Removal/installation	Disassembly/assembly	Cleaning, inspection and repair
Bayonet-Knife, M4	Refer to TM 9-1005-210-12	Refer to TM 9-1005-237-15P	Refer to TM 9-1005-210-12 for cleaning and lubrication. Inspect components for burs and remove. Inspect components for damage and repair or replace unserviceable parts. Refer to TM 9-1005-237-15P for authorized parts. <i>Note.</i> Bayonet must fit snugly and lock positively in position.
Bayonet-Knife Scabbard, M8A1			Refer to TM 9-1005-210-12 for cleaning. Inspect for general appearance and condition. Inspect components for damage. Refer to TM 9-1005-237-15P for authorized parts. <i>Note.</i> Scabbard must retain bayonet securely.



CHAPTER 5

FINAL INSPECTION

5-1. General

- a. Make certain that the carbines are inspected and repaired as indicated in table 3-1.
- b. Function-fire carbines after repair, when possible, to be sure they operate properly.
- c. Visually check all assemblies after firing weapon.
- d. Clean and lubricate carbines after firing.

5-2. Visual Inspection

Overall appearance will be approximately that of a new weapon. All exposed metal surfaces are to have a dull, rust resistant finish

with no burs or deep scratches. Barrels must be straight, clean, free from rust and powder fouling, and free of bulges and rings. Fine pitting is allowable. Carbines must be complete with no missing parts. All modifications must be applied. The serial numbers must be legible. All metal parts must be free of rust

5-3. Completion of Inspection

Upon completion of inspection, and when carbines have been restored to a serviceable condition, it shall be certified that the weapon is acceptable for "return to user" or for "return to stock."



APPENDIX A

REFERENCES

A-1. General

Refer to TM 9-1005-210-12 and paragraph A-2 below.

A-2. Other Publications

Operator's and Organizational Maintenance Manual Including Repair Parts and Special Tools List for Carbines, Caliber .30, M1 and M2 ----- TM 9-1005-210-12

DS Maintenance Manual: Repair of Wooden, Fiber Glass/Plastic or Plastic Components of Small Arms Weapons ----- TM 9-1005-301-30

Standards for Oversea Shipment or Domestic Issue of Small Arms, Aircraft Armament, Towed Howitzers, Mortars, Recoilless Rifles, Rocket Launchers and Associated Fire Control Equipment ----- TB 9-1000-247-85



APPENDIX B

DIRECT SUPPORT, GENERAL SUPPORT, AND DEPOT

MAINTENANCE REPAIR PARTS AND SPECIAL TOOLS LIST

Section I. INTRODUCTION

B-1. Scope

This appendix lists repair parts, special tools, and equipment required for the performance of direct support, general support, and depot maintenance of the Carbines, M1 and M2.

B-2. General

This Repair Parts and Special Tools List is divided into the following sections:

a. *Repair Parts—Section II.* A list of repair parts authorized for the performance of maintenance at the direct support, general support, and depot level in figure and item number sequence.

b. *Special Tools, Test and Support Equipment—Section III.* A list of special tools, test and support equipment authorized for the performance of maintenance at the direct support, general support, and depot level.

c. *Federal Stock Number and Reference Number Index—Section IV.* A list of Federal stock numbers in ascending numerical sequence followed by a list of reference numbers in ascending alpha-numeric sequence, cross-referenced to the illustration figure number and item number.

B-3. Explanation of Columns

The following provides an explanation of columns in the tabular lists in Sections II and III.

a. *Source, Maintenance, and Recoverability Codes (SMR), Column 1:*

(1) *Source Code.* Indicates the selection status and source for the listed item. Source

Code	Explanation
P	Repair parts which are stocked in or supplied from the GSA/DSA, or Army supply system, and authorized for use at indicated maintenance categories.

Code	Explanation
P2	Repair parts which are procured and stocked for insurance purposes because the combat or military essentiality of the end item dictates that a minimum quantity be available in the supply system.
A	Assemblies which are not procured or stocked as such but are made up of two or more units. Such component units carry individual FSN's and descriptions, are procured and stocked separately and can be assembled to form the required assembly at indicated maintenance categories.
X	Parts and assemblies which are not procured or stocked and the mortality of which is normally below that of the applicable end item or component. The failure of such part or assembly should result in retirement of the end item from the supply system.
X1	Repair parts which are not procured or stocked, the requirement for such item will be filled by use of next higher assembly or component.
X2	Repair parts which are not stocked. The indicated maintenance category requiring such repair parts will attempt to obtain through cannibalization; if not obtainable through cannibalization, such repair parts will be requisitioned with supporting justification through normal supply channels.
G	Major assemblies that are procured with PEMA funds for initial issue only to be used as exchange assemblies at DSU and GSU level. These assemblies will not be stocked above DSU and GSU level or returned to Depot supply level.

(2) *Maintenance Code.* Indicates the lowest category of maintenance authorized to install the repair part. The maintenance level codes are:

Code	Maintenance Category
C	Crew or Operator
O	Organizational
F	Direct Support
H	General Support
D	Depot

(3) *Recoverability Codes.* Indicate whether unserviceable repair parts/or tools and test equipment will be returned for recovery or salvage. Items not coded are expendable. The recoverability codes are:

Code	Recoverability Aspect
R	Applied to repair parts (assemblies and components) which are considered economically repairable at Direct and General support maintenance levels. When the maintenance capability to repair these items does not exist, they are normally disposed of at the GS level. When supply considerations dictate, some of these repair parts may be listed for automatic return to supply for Depot level repair as set forth in AR 710-50. When so listed, they will be replaced by supply on an exchange basis.
S	Repair parts and assemblies which are economically repairable at DSU and GSU activities and normally are furnished by supply on an exchange basis. When items are determined by a GSU to be uneconomically repairable, they will be evacuated to a depot for evaluation and analysis before final disposition.
T	High dollar value recoverable repair parts which are subject to special handling and are issued on an exchange basis. Such repair parts are normally repaired or overhauled at depot maintenance activities.
U	Repair parts specifically selected for salvage by reclamation units because of precious metal content, critical materials, high dollar value reusable casings or castings.
No Code indicated	Part will be considered expendable.

b. Federal Stock Number, Column 2. This column indicates the Federal stock number assigned to the item and will be used for repositioning purposes.

c. Description, Column 3. This column indicates the Federal item name and any additional description of the item required. The abbreviation "w/e" when used as a part of the nomenclature, indicates the Federal stock number includes all armament, equipment, accessories, and repair parts issued with the item. A part number or other reference number is followed by the applicable five-digit Federal supply code for manufacturers in parentheses.

d. Unit of Measure (U/M), Column 4. A character alphabetic abbreviation indicating the amount or quantity of the item upon which the allowances are based, e.g., ft, ea, r, etc.

e. Quantity Incorporated in Unit, Column 5. This column indicates the quantity of the item used in the functional group. A "V" appearing in this column in lieu of a quantity

indicates that a definite quantity cannot be indicated (e.g., shims, spacers, etc.).

f. 30-Day DS/GS Maintenance Allowance, Columns 6 and 7.

Note. Allowances in GS column are for GS maintenance only.

(1) The allowance columns are divided into three subcolumns. Indicated in each subcolumn, opposite the first appearance of each item, is the total quantity of items authorized for the number of equipments supported. Subsequent appearances of the same item will have the letters "REF" in the applicable allowance columns. Items authorized for use as required but not for initial stockage are identified with an asterisk in the allowance column.

(2) The quantitative allowances for DS/GS levels of maintenance will represent initial stockage for a 30-day period for the number of equipments supported.

(3) Determination of the total quantity of parts required for maintenance of more than 100 of these equipments can be accomplished by converting the equipment quantity to a decimal factor by placing a decimal point before the next to last digit of the number to indicate hundredths, and multiplying the decimal factor by the parts quantity authorized in the 51-100 allowance column. Example, authorized allowance for 51-100 equipments is 40; for 150 equipments multiply 40 by 1.50 or 60 parts required.

g. 1-Year Allowances Per 100 Equipments/Contingency Planning Purposes, Column 8. This column indicates opposite the first appearance of each item the total quantity required for distribution and contingency planning purposes. The range of items indicates total quantities of all authorized items required for distribution and contingency planning purposes. The range of items indicates total quantities of all authorized items required to provide for adequate support of 100 equipments for one year.

h. Depot Maintenance Allowance Per 100 Equipments, Column 9. This column indicates opposite the first appearance of each item, the total quantity authorized for depot maintenance of 100 equipments. Subsequent appearances of the same item will have the letters "REF" in the allowance column. Items authorized for use as required but not for initial stockage are identified with an asterisk in the allowance column.

i. *Illustration, Column 10.* This column is divided as follows:

(1) *Figure Number, Column 10a.* Indicates the figure number of the illustration in which the item is shown.

(2) *Item Number, Column 10b.* Indicates the callout number used to reference the item in the illustration.

B-4. Special Information

Identifications of the usable on codes included in column 3 of this publication are:

Code	Used on
No Code	M1 and M2
A	M1
B	M2

B-5. How to Locate Repair Parts

a. When Federal stock number or reference number is unknown:

(1) *First.* Using the table of contents, determine the functional group or assembly within which the repair parts belongs. This is necessary since illustrations are prepared for functional groups or assemblies and listings are divided into the same groups.

(2) *Second.* Find the illustration covering the functional group or assembly to which the repair part belongs.

(3) *Third.* Identify the repair part on the illustration and note the illustration figure and item number of the repair part.

(4) *Fourth.* Using the Repair Parts Listing, find the functional group or assembly to which the repair part belongs and locate the illustration figure and item number noted on the illustration.

b. When Federal stock number or reference number is known:

(1) *First.* Using the Index of Federal Stock Numbers and Reference Numbers find the pertinent Federal stock number or reference number. This index is in ascending FSN sequence followed by a list of reference numbers in ascending alpha-numeric sequence, cross-referenced to the illustration figure number and item number.

(2) *Second.* Using the Repair Part Listing, find the functional group or assembly of the repair part and the illustration figure number and item number referenced in the Index of Federal Stock Numbers and Reference Numbers.

B-6. Abbreviations

Abbreviation	Explanation
BLK	black
CAP	capacity
CHAM	chamfer
F-FIL-HD	flat fillister head
GND	ground
NON-STD	nonstandard
O/A	over-all
PHOS-FIN	phosphate finish
SGL	single
SQ-DRIVE	square drive
SYNTH-RBR	synthetic rubber
TPI	threads per inch

B-7. Federal Supply Codes for Manufacturers

Code	Manufacturer
19203	Picatinney Arsenal
19204	Rock Island Arsenal
19205	Springfield Armory
19207	U. S. Army Tank Automotive Command
81348	Federal Specification

Section II. REPAIR PARTS LIST

(1) Source, maint. & recov. code			(2) Federal stock number	(3) Description Reference Number & Mfr Code Usable on Code	(4) Unit of meas	(5) Qty. inc. in unit	(6) 30-day ds maint. alw.			(7) 30-day gs maint. alw.			(8) 1-yr. alw per. 100 equip cntgy.	(9) Depot maint. alw. per 100 equip.	(10) Illustration	
(a) Source	(b) Maint.	(c) Recov.					(a) 1-20	(b) 21-50	(c) 51- 100	(a) 1-20	(b) 21-50	(c) 51- 100			(a) Fig. No.	(b) Item No.
P	C	...	1005-716-2176	REPAIR PARTS FOR: MAJOR GROUPS, ASSEMBLIES AND COMPONENTS MAGAZINE, CARTRIDGE: (30 CARTRIDGE CAP.) 7162176 (19205)	EA	1	7	16	29	7	16	29	348	15	B1	1
P	O	...	1005-621-2602	GUARD, HAND, GUN: WALNUT OR BIRCH, 4 RIVETS 6212602 (19205)	EA	1	2	3	6	2	3	6	72	50	B1	2
A	STOCK GROUP	1	B1	3
P	O	...	1005-620-0985	GUIDE, OPERATING SLIDE SPRING: 6200985 (19205)	EA	1	2	3	6	2	3	6	72	5	B1	4
P	O	...	1005-519-6466	SPRING, HELICAL, COMPRESSION: S, 0.036 DIA STK, 0.256 OD, 121 COILS, OPERATING SLIDE 5196466 (19205)	EA	1	2	2	3	2	2	3	36	100	B1	5
P	O	...	1005-716-1839	SPRING, SELECTOR: 7161839 (19205)	EA	1	3	6	11	3	6	11	132	24	B1	6
P	F	...	1005-716-1838	SELECTOR, RATE: 7161838 (19204)	EA	1	2	2	3	2	2	3	36	20	B1	7
P	F	...	1005-716-1830	LEVER, DISCONNECTOR: (MFR ASSY) 7161830 (19204)	EA	1	2	2	3	2	2	3	36	21	B1	8
A	HOUSING ASSEMBLY, TRIGGER: 7161829	...	1	B1	9
P	O	...	5315-519-6450	PIN, STRAIGHT, HEADED: S, PHOS-FIN., 0.178 IN. MIN DIA, 0.179 IN. MAX DIA, 60 DEG CHAM (TRIGGER	EA	1	2	3	6	2	3	6	72	8	B1	10

(1) Source, maint. & recov. code			(2) Federal stock number	(3) Description		(4) Unit of meas	(5) Qty. inc. in unit	(6) 30-day ds maint. alw.			(7) 30-day gs maint. alw.			(8) 1-yr. alw per. 100 equip cntgy.	(9) Depot maint. alw. per 100 equip.	(10) Illustration	
(a) Source	(b) Maint.	(c) Recov.						(a) 1-20	(b) 21-50	(c) 51- 100	(a) 1-20	(b) 21-50	(c) 51- 100			(a) Fig. No.	(b) Item No.
Reference Number & Mfr Code			Usable on Code														
A	HOUSING) 5196450 (19204)	A	...	1	B1	11	
P	F	...	1005-716-1843	HOUSING ASSEMBLY, TRIGGER: 6544005	A	EA	1	2	2	3	2	2	3	36	3	B1	12
P	F	...	1005-731-2452	SLIDE, OPERATING: 7161843 (19205)		EA	1	2	2	3	2	2	3	36	42	B1	13
P	F	...	1005-731-2453	STOP, OPERATING SLIDE: 7312452 (19205)		EA	1	2	2	3	2	2	336	100	B1	14	
				SPRING, HELICAL, COMPRESSION S, 0.022 DIA STK, 0.128 OD, 8 COILS, OPERATING SLIDE STOP 7312453 (19205)		EA	1	2	2	3	2	2	336	100	B1	14	
A	BOLT ASSEMBLY: 7162897		...	1	B1	15	
X	BARREL AND RECEIVER GROUP		...	1	B1	16	
P	F	...	1005-614-6873	STOCK GROUP SCREW, BUTT PLATE, SMALL: (SPECIAL, WOOD, S, 0.212 DIA, 10 TPI, 0.925 OVER-ALL) 6146873 (19205)		EA	1	2	2	3	2	2	3	36	6	B2	1
P	F	...	1005-620-0997	PLATE, BUTT, SHOULDER GUN: 6200997 (19205)		EA	1	2	2	3	2	2	3	36	24	B2	2
P	F	...	1005-519-6484	SPRING, LOCKING, RETAINING BAND: 5196484 (19205)		EA	1	2	2	3	2	2	3	36	9	B2	3
P	F	R	1005-716-1845	STOCK ASSEMBLY: 7161845 (19205)		EA	1	2	2	3	2	2	3	36	21	B2	4
P	D	...	5305-519-6442	SCREW, MACHINE: 5196442 (19204)		EA	1	4	B2	5
P	D	...	1005-555-7150	PLATE, RECOIL: 5557150 (19205)		EA	1	4	B2	6
P	D	...	5310-519-6440	NUT, PLAIN, KNURLED: 0.200 IN.-40 NON-STD, 0.410 IN. H, 0.265 IN.		EA	1	4	B2	7

Source, maint. & recov. code			Federal stock number	Description	Unit of meas	Qty. inc. in unit	30-day ds maint. alw.			30-day gs maint. alw.			1-yr. alw per. 100 equip cmty.	Depot maint. alw. per 100 equip.	Illustration	
(a) Source	(b) Maint.	(c) Recov.					(a) 1-20	(b) 21-50	(c) 51-100	(a) 1-20	(b) 21-50	(c) 51-100			(a) Fig. No.	(b) Item No.
				Reference Number & Mfr Code												
X1	1005-928-6167	W, 0.400 IN, DIA, S, PHOS- FINISH 5196440 (19204) STOCK, GUN SHOULDER: BLK WALNUT OR BIRCH, 4.010 MAX BUTT W, 28-350 O/A LG 7161844 (19205) TRIGGER HOUSING ASSEMBLY	EA	1	B2	8
P	O	...	1005-620-0981	PLUNGER, HAMMER SPRING: 6200981 (19205)	EA	1	2	3	6	2	3	6	72	5	B3	1
P	O	...	1005-537-7921	SPRING, HELICAL, COMPRESSION: S, 0.042 DIA STK, 0.280 OD, 26.5 COILS HAMMER 5377921 (19205)	EA	1	2	3	6	2	3	6	72	100	B3	2
P	O	...	5315-519-6449	PIN, STRAIGHT, HEADED: S, FL-FIL-HD, 0.159 IN. MIN DIA, 0.160 IN. MAX DIA, 45 DEG CHAM (HAMMER) 5196449 (19204)	EA	1	2	3	6	2	3	6	72	6	B3	3
P	O	...	1005-716-1840	HAMMER, FIRING, SMALL ARMS: 7161840 (19204)	EA	1	*	2	2	*	2	2	24	20	B3	4
P	O	...	1005-565-3447	HAMMER, FIRING, SMALL ARMS: 5653447 (19204)	EA	1	*	2	2	*	2	2	24	14	B3	5
P	F	...	1005-716-1837	DISCONNECTOR, TRIGGER HOUSING: 7161837 (19205)	EA	1	2	2	3	2	2	3	36	19	B3	6
P	O	...	1005-716-2782	PLUNGER, DISCONNECTOR SPRING: (MFR ASSY) 7162782 (19205)	EA	1	2	3	6	2	3	6	72	100	B3	7
P	O	...	1005-519-6459	SPRING, HELICAL, TORSION: TRIGGER 5196459 (19205)	EA	1	3	6	11	3	6	11	132	100	B3	8

(1) Source, maint. & recov. code			(2) Federal stock number	(3) Description Reference Number & Mfr CodeUsable on Code	(4) Unit of meas	(5) Qty. inc. in unit	(6) 30-day ds maint. alw.			(7) 80-day gs maint. alw.			(8) 1-yr. alw per. 100 equip cntgcy.	(9) Depot maint. alw. per 100 equip.	(10) Illustration	
(a) Source	(b) Maint.	(c) Recov.					(a) 1-20	(b) 21-50	(c) 51- 100	(a) 1-20	(b) 21-50	(c) 51- 100			(a) Fig. No.	(b) Item No.
P	F	...	5315-519-6453	PIN, STRAIGHT, HEADLESS: S, PHOS-FIN., 0.124 DIA, 0.125 MAX DIA (TRIGGER) 5196453 (19204)	EA	1	2	3	6	2	3	6	72	11	B3	9
P	O	...	1005-716-1841	SEAR: 7161841 (19205)	EA	1	2	2	3	2	2	3	36	30	B3	10
P	O	...	1005-537-7984	SPRING, HELICAL, COMPRESSION: S, 0.023 DIA STK, 0.143 OD, 15 COILS, SEAR 5377984 (19205)	EA	1	2	2	3	2	2	3	36	100	B3	11
P	F	...	1005-620-0988	TRIGGER: 6200988 (19205)	EA	1	2	2	3	2	2	3	36	12	B3	12
P	F	...	1005-716-1842	CATCH, MAGAZINE: 7161842 (19205)	EA	1	2	2	3	2	2	3	36	15	B3	13
P	F	...	1005-614-7695	PLUNGER ASSEMBLY, MAGAZINE CATCH: 6147695 (19205)	EA	1	2	3	6	2	3	6	72	100	B3	14
P	F	...	1005-716-0472	PLUNGER ASSEMBLY, MAGAZINE CATCH RETAINER: W/PLUNGER, SAFETY 7160472 (19205)	EA	1	2	2	3	2	2	3	36	100	B3	15
P	F	...	1005-716-2080	SAFETY, SMALL ARMS: 7162080 (19205)	EA	1	*	2	2	*	2	2	24	20	B3	16
P	D	...	1005-716-1828	HOUSING, TRIGGER: 7161828 (19205) BOLT ASSEMBLY	EA	1	3	B3	17
P	O	...	1005-620-0987	EXTRACTOR, CARTRIDGE: 6200987 (19205)	EA	1	2	3	6	2	3	6	72	25	B4	1
P	O	...	1005-519-6437	PLUNGER, EXTRACTOR SPRING: 5196437 (19205)	EA	1	2	3	6	2	3	6	72	100	B4	2
P	O	...	1005-313-9442	SPRING, HELICAL, COMPRESSION: S, 0.026 DIA STK, 0.123 OD, 10 COILS, EXTRACTOR PLUNGER 7267690 (19205)	EA	1	2	2	3	2	2	3	36	100	B4	3

9	(1) Source, maint. & recov. code		(2) Federal stock number	(3) Description		(4) Unit of meas	(5) Qty. inc. in unit	(6) 30-day ds maint. alw.			(7) 30-day gs maint. alw.			(8) 1-yr. alw per. 100 equip cntgcy.	(9) Depot maint. alw. per 100 equip.	(10) Illustration	
	(b) Maint.	(c) Recov.						(a) 1-20	(b) 21-50	(c) 51- 100	(a) 1-20	(b) 21-50	(c) 51- 100			(a) Fig. No.	(b) Item No.
8				Reference Number & Mfr Code	Usable on Code												
F	O	...	1005-621-2601	EJECTOR, CARTRIDGE: 6212601 (19205)		EA	1	2	3	6	2	3	6	72	100	B4	4
X	EJECTOR 6200989		...	1	B4	5
F	F	...	1005-519-6462	SPRING, HELICAL, COMPRESSION: S, 0.026 DIA STK, 0.122 OD, 27.5 COILS, EJECTOR 5196462 (19205)		EA	1	2	3	6	2	3	6	72	100	B4	6
P	O	...	1005-620-0976	PIN, FIRING: 6200976 (19204)		EA	1	*	2	2	*	2	2	24	40	B4	7
P	F	...	1005-716-0092	BOLT, BREECH: 7160092 (19205) BARREL AND RECEIVER GROUP		EA	1	2	2	3	2	2	3	36	7	B4	8
P	D	...	1005-555-7154	BARREL ASSEMBLY, CARBINE: 5557154 (19205)		EA	1	14	B5	1
P	F	...	5315-519-6482	PIN, STRAIGHT, HEADLESS: S, GND, 0.1245 MIN DIA, 0.1250 MAX DIA, 0.520 LG (FRONT SIGHT) 5196482 (19204)		EA	1	*	*	2	*	*	2	24	9	B5	2
P	F	...	1005-620-0995	SIGHT, FRONT: 6200995 (19205)		EA	1	2	2	3	2	2	3	36	17	B5	3
P	F	...	1005-519-6451	KEY, FRONT SIGHT: 5196451 (19205)		EA	1	2	2	3	2	2	3	36	13	B5	4
P	F	...	1005-716-0963	BAND, RETAINING, GUN HAND GUARD AND STOCK: FRONT 7160963 (19205)		EA	1	2	3	6	2	3	6	72	10	B5	5
P	F	...	5305-299-1269	SCREW, FRONT BAND: 7160004 (19203)		EA	1	2	2	3	2	2	3	36	20	B5	6
X1	BAND GROUP		...	1	B5	7
P	F	...	1005-519-6436	NUT, PISTON: 5196436 (19205)		EA	1	2	2	3	2	2	3	36	80	B5	8
P	F	...	1005-519-6446	PISTON, GUN GAS CYLINDER: 5196446 (19205)		EA	1	2	2	3	2	2	3	36	7	B5	9

(1) Source, maint. & recov. code			(2) Federal stock number	(3) Description Reference Number & Mfr Code Usable on Code	(4) Unit of meas	(5) Qty. inc. in unit	(6) 30-day ds maint. alw.			(7) 30-day gs maint. alw.			(8) 1-yr. alw per. 100 equip cntgy.	(9) Depot maint. alw. per 100 equip.	(10) Illustration	
(a) Source	(b) Maint.	(c) Recov.					(a) 1-20	(b) 21-50	(c) 51- 100	(a) 1-20	(b) 21-50	(c) 51- 100			(a) Fig. No.	(b) Item No.
X1	BARREL, W/GAS CYLINDER (MFR ASSY) 5564365	...	1	B5	10
P	F	...	1005-657-3955	SIGHT, REAR: ASJUSTABLE 6573955 (19207) OR	EA	1	2	2	3	2	2	3	36	24	B5	11
P	F	...	1005-716-0060	SIGHT, REAR: ADJUSTABLE 7160060 (19205)	EA											
X	RECEIVER, DEEP HOLE TYPE 7265615	...	1	B5	12
X1	OILER CAP, OILER (MFR ASSY) 5196480	...	1	B6	1
P	O	...	1005-519-6456	GASKET: SYNTH-RBR, 0.200 IN. ID, 0.383 IN. OD, 0.060 IN. THK, OILER TUBE 5196456 (19205)	EA	1	3	6	11	3	6	11	132	8	B6	2
X1	TUBE, OILER (MFR ASSY) 5196481	...	1	B6	3
P	F	...	1005-523-3523	MATERIAL FOR REPAIR OF WOODEN COMPONENTS SCREW: STOCK REPAIR, LARGE 3/32 DIA, 2-7/16 LG 5233523 (19205)	EA	*	*	*	*	*	*	*	...	*		
P	F	...	1005-719-0954	SCREW, STOCK REPAIR, SMALL: 1/16 DIA, 2 LG 7190954 (19205)	EA	*	*	*	*	*	*	*	...	*		
P	O	...	1005-317-2479	ITEMS REQUIRED FOR ENGINEER CORPS THE FOLLOWING ITEMS ARE REQUIRED WHEN THE SNIPERSCOPE, M2, MOUNT ASSEMBLY, IS INSTALLED ON THE CARBINE, M2 (ITEMS SHALL BE REQUISITIONED AS REQUIRED). GUARD, HAND, GUN: 7267170 (19205)	EA	1	*	*	*	*	*	*				

Source, maint. & recov. code			Federal stock number	Description	Unit of meas	Qty. inc. in unit	80-day ds maint. alw.			80-day gs maint. alw.			1-yr. alw per. 100 equip cntgcy.	Depot maint. alw. per 100 equip.	(10) Illustration	
(a) Source	(b) Maint.	(c) Recov.					(a) 1-20	(b) 21-50	(c) 51-100	(a) 1-20	(b) 21-50	(c) 51-100			(a) Fig. No.	(b) Item No.
P	O	...	1005-317-2480	STOCK, GUN, SHOULDER: 7267171 (19205)	EA	1	*	*	*	*	*	*				
P	O	...	5305-716-1244	SCREW, SELF LOCKING: 7161244 (19205)	EA	1	*	*	*	*	*	*				

Section III. SPECIAL TOOLS, TEST AND SUPPORT EQUIPMENT

(1) Source, maint. & recov. code			(2) Federal stock number	(3) Description Reference Number & Mfr Code Usable on Code	(4) Unit of meas	(5) Qty. inc. in unit	(6) 30-day ds maint. alw.			(7) 80-day gs maint. alw.			(8) 1-yr. alw per. 100 equip cntgy.	(9) Depot maint. alw. per 100 equip.	(10) Illustration	
(a) Source	(b) Maint.	(c) Recov.					(a) 1-20	(b) 21-50	(c) 51- 100	(a) 1-20	(b) 21-50	(c) 51- 100			(a) Fig. No.	(b) Item No.
			1005-288-3565	TOOLS AND EQUIPMENT AUTHORIZED FOR UNIT REPLACEMENT SWAB, SMALL ARMS CLEANING: COTTON, 2-1/2 SQ (1000 IN PG) 5019316 (19204)	EA	...	*	*	*	*	*	*
			1005-550-6573	CASE, SMALL ARMS CLEANING ROD: 5506573 (19204)	EA	...	*	2	2	*	2	2	24	...	B7	5
			1005-555-7152	SLING, SMALL ARMS: M1, WEBBING 5557152 (19204)	EA	...	2	3	6	2	3	6	72	...	B7	10
			1005-556-4174	BRUSH, CLEANING, SMALL ARMS: BORE 5564174 (19204)	EA	...	3	6	11	3	6	11	132	...	B7	2
			1005-556-4364	OILER, CARBINE: 5564364 (19204)	EA	...	2	2	3	2	2	3	36	...	B7	8
			1005-694-1662	BUFFER, CLEANING ROD: 7268275 (19204)	EA	...	2	3	6	2	3	6	72	...	B7	3
			1005-716-2546	CAP, MAGAZINE: 7162546 (19204)	EA	...	9	20	38	9	20	38	456	...	B7	4
			1005-726-6109	ROD SECTION, CLEANING, SMALL ARMS: 7266109 (19205)	EA	...	3	6	11	3	6	11	132	...	B7	9
			1005-726-6110	SWAB HOLDER SECTION, SMALL ARMS CLEANING ROD: 7266110 (19204)	EA	...	2	3	6	2	3	6	72	...	B7	1
			1005-793-6761	HANDLE ASSEMBLY: CLEANING ROD 7266115 (19204)	EA	...	2	2	3	2	2	3	36	...	B7	7
			4933-562-1065	WRENCH, SPANNER: REMOVING, GAS PISTON NUT, M5 5621065 (19205)	EA	...	*	2	2	*	2	2	24	...	B8	2

(1) Source, maint. & recov. code			(2) Federal stock number	(3) Description	(4) Unit of meas	(5) Qty. inc. in unit	(6) 80-day ds maint. alw.			(7) 80-day gs maint. alw.			(8) 1-yr. alw per. 100 equip cntgcy.	(9) Depot maint. alw. per 100 equip.	(10) Illustration	
(a) Source	(b) Maint.	(c) Recov.		Reference Number & Mfr Code			(a) 1-20	(b) 21-50	(c) 51-100	(a) 1-20	(b) 21-50	(c) 51-100			(a) Fig. No.	(b) Item No.
R			4933-716-0026	TOOL, REMOVING, TRIGGER SPRING: 7160026 (19205)	EA	...	*	2	2	*	2	2	24	...	B8	3
			4933-731-3298	TOOL ASSEMBLY, BOLT, CARBINE: ASSEMBLING AND DISASSEMBLING 7313298 (19205)	EA	...	*	2	2	*	2	2	24	...	B8	1
			9150-248-3480	GREASE, RIFLE: MINERAL OIL AND CALCIUM SOAP, 5 CC TUBE 5621059 (19204)	CC	...	2	4	8	2	4	8	96	...	B7	6
			4933-775-0366	TOOLS AND EQUIPMENT THE FOLLOWING TOOL SET IS AUTHORIZED AND MAY BE REQUISITIONED BY PERSONNEL AUTHORIZED FIELD MAINTENANCE SMALL ARMS SHOP SET 4933-754-0664-A18. TOOL SET, DIRECT AND GENERAL SUPPORT MAINTENANCE, BASIC SMALL ARMS: 8426358 (19205) NOTE: SEE SC 4933-95-CL-E04 FOR COMPONENTS. THE FOLLOWING TOOL SETS ARE REQUISITIONED AND ISSUED TO MAINTENANCE UNITS PERFORMING DIRECT AND GENERAL SUPPORT OR DEPOT MAINTENANCE. THE COMPLETE SET WILL BE REQUISITIONED AND INDIVIDUAL TOOLS LISTED BELOW MAY ALSO BE REQUISITIONED UNDER THEIR OWN STOCK NUMBER FOR REPLACEMENT. THE 30-DAY LEVEL IS NOT APPLICABLE.	SE	...	*	*	*	*	*	*

(1) Source, maint. & recov. code			(2) Federal stock number	(3) Description Reference Number & Mfr Code Usable on Code	(4) Unit of meas	(5) Qty. inc. in unit	(6) 30-day ds maint. alw.			(7) 30-day gs maint. alw.			(8) 1-yr. alw per. 100 equip catgy.	(9) Depot maint. alw. per 100 equip.	(10) Illustration	
(a) Source	(b) Maint.	(c) Recov.					(a) 1-20	(b) 21-50	(c) 51- 100	(a) 1-20	(b) 21-50	(c) 51- 100			(a) Fig. No.	(b) Item No.
R			4933-726-5826	TOOL SET, DIRECT AND GENERAL SUPPORT MAINTENANCE FOR CARBINE, CAL. 30, M1 AND M2 7265826 (19205) CONSISTING OF:	SE	...	*	*	*	*	*	*
			4933-562-1065	WRENCH, SPANNER: GAS PISTON NUT 5621065 (19205)	EA	1	*	*	*	*	*	*	B9	8
			4933-716-0026	TOOL, REMOVING, TRIGGER SPRING: 7160026 (19205)	EA	1	*	*	*	*	*	*	B9	9
			4933-716-0995	TOOL, GAS CYLINDER, RECONDITIONING: 7160995 (19205)	EA	3	*	*	*	*	*	*	B9	7
			4933-716-1237	TOOL, REMOVING, FRONT SIGHT: 7161237 (19205)	EA	1	*	*	*	*	*	*	B9	3
			4933-716-1313	TOOL, ASSEMBLING, FRONT SIGHT: 7161313 (19205)	EA	1	*	*	*	*	*	*	B9	4
			4933-731-2068	TOOL, ASSEMBLING, ADJUSTABLE, REAR SIGHT: 7312068 (19205)	EA	1	*	*	*	*	*	*	B9	10
			4933-731-3298	TOOL ASSEMBLY, BOLT, CARBINE: ASSEMBLING AND DISASSEMBLING, 7313298 (19205)	EA	1	*	*	*	*	*	*	B9	5
			4933-731-9932	BOLT, FIELD TEST: 7319932 (19205)	EA	1	*	*	*	*	*	*	B9	2
			4933-731-9943	GAGE, HEADSPACE: 1.302 7319943 (19205)	EA	1	*	*	*	*	*	*	B9	6
			5120-529-2552	WRENCH, TORQUE: INDICATING, 1/4 IN. SQ-DRIVE, 60 IN.-LB CAP., IN METAL CASE GGG W 686 (81348)	EA	1	*	*	*	*	*	*	B9	1
R			4933-726-5825	TOOL SET, DEPOT MAINTENANCE: FOR	SE	*		

(1) Source, maint. & recov. code			(2) Federal stock number	(3) Description Reference Number & Mfr Code Usable on Code	(4) Unit of meas	(5) Qty. inc. in unit	(6) 30-day ds maint. alw.			(7) 30-day gs maint. alw.			(8) 1-yr. alw per. 100 equip entgcy.	(9) Depot maint. alw. per 100 equip.	(10) Illustration	
(a) Source	(b) Maint.	(c) Recov.					(a) 1-20	(b) 21-50	(c) 51- 100	(a) 1-20	(b) 21-50	(c) 51- 100			(a) Fig. No.	(b) Item No.
				CARBINE, CAL. .30, M1 AND M2 7265825 (19205) CONSISTING OF: 4933-332-4199 GAGE, HEADSPACE: 1.298 7319942 (19205) 4933-711-3308 WRENCH, RECEIVER AND BARREL: 7113308 (19204) 4933-714-8683 REAMER ASSEMBLY, HEADSPACE: 7148683 (19204) 4933-731-9934 GAGE, HEADSPACE: 1.290 7319934 (19205) 4933-731-9936 GAGE, HEADSPACE: 1.295 7319936 (19205) 4933-937-7328 GAGE, FLUSH PIN: DISCONNECTOR LEVER CAM 7799843 (19204) 4933-937-7329 GAGE, WIDTH: DISCONNECTOR LEVER CLEARANCE CUT 7799844 (19204) 4933-937-7330 GAGE, PLUG, SPECIAL: TRIGGER HOUSING RETAINING PIN HOLE DIA 7799845 (19204) 4933-937-7331 GAGE, PLUG, SPECIAL: BOLT OVER STRIKER HOLE 7799846 (19204) 4933-937-7332 GAGE, HEIGHT: FRONT SIGHT BLADE 7799847 (19204) 4933-937-7333 GAGE, SNAP: SGL END, PISTON HD DIA 7799848 (19204) 4933-937-7334 GAGE, FIRING PIN PROTRUSION: 7799849 (19204)	EA	2	*		
					EA	2	*		
					EA	2	*		
					EA	2	*		
					EA	1	*		
					EA	1	*		
					EA	1	*		
					EA	1	*		
					EA	1	*		
					EA	1	*		
					EA	1	*		
					EA	1	*		

(1) Source, maint. & recov. code			(2) Federal stock number	(3) Description	(4) Unit of meas	(5) Qty. inc. in unit	(6) 30-day ds maint. alw.			(7) 30-day gs maint. alw.			(8) 1-yr. alw per. 100 equip entgy.	(9) Depot maint. alw. per 100 equip.	(10) Illustration	
(a) Source	(b) Maint.	(c) Recov.					(a) 1-20	(b) 21-50	(c) 51- 100	(a) 1-20	(b) 21-50	(c) 51- 100			(a) Fig. No.	(b) Item No.
			Reference Number & Mfr Code	Usable on Code												
			4933-937-7335	GAGE, PLUG: SGL END, GAS PORT DIAMETER 7799850 (19204)	EA	1	*		
			4933-937-7336	GAGE, PLUG, SPECIAL: GAS CYLINDER PISTON HOLE DIA 7799851 (19204)	EA	1	*		
			6920-713-8437	SPECIAL EQUIPMENT THE FOLLOWING ITEM IS AUTHORIZED FOR DEPOT REBUILD PROGRAMS ONLY. TARGET, SILHOUETTE: 1000 IN. RANGE, ROLL OF 500 PER BOX 7138437 (19205)	EA	*		

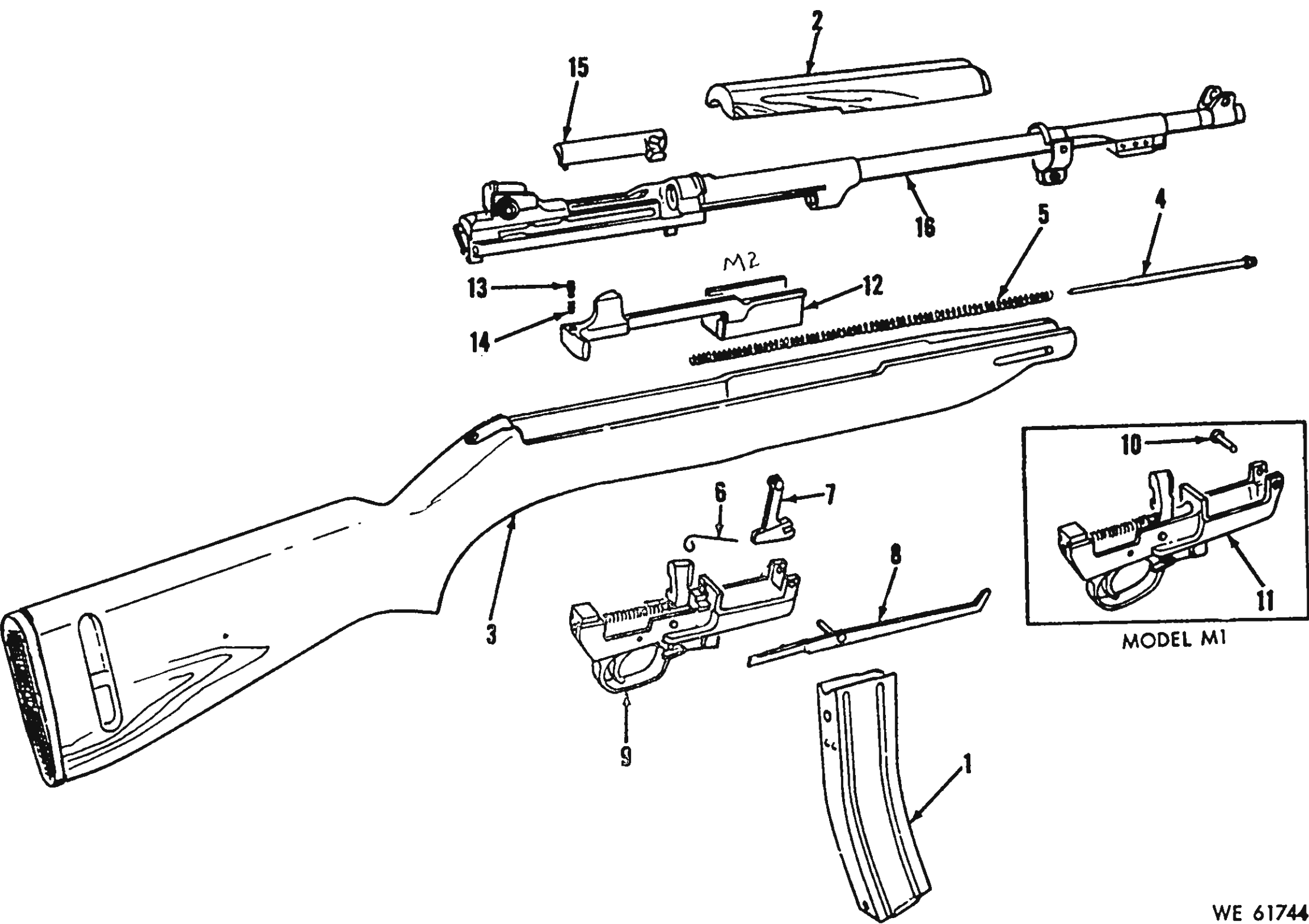

WE 61744

Figure B-1. Major groups, assemblies, and components for Carbines Caliber .30, M1 and M2.

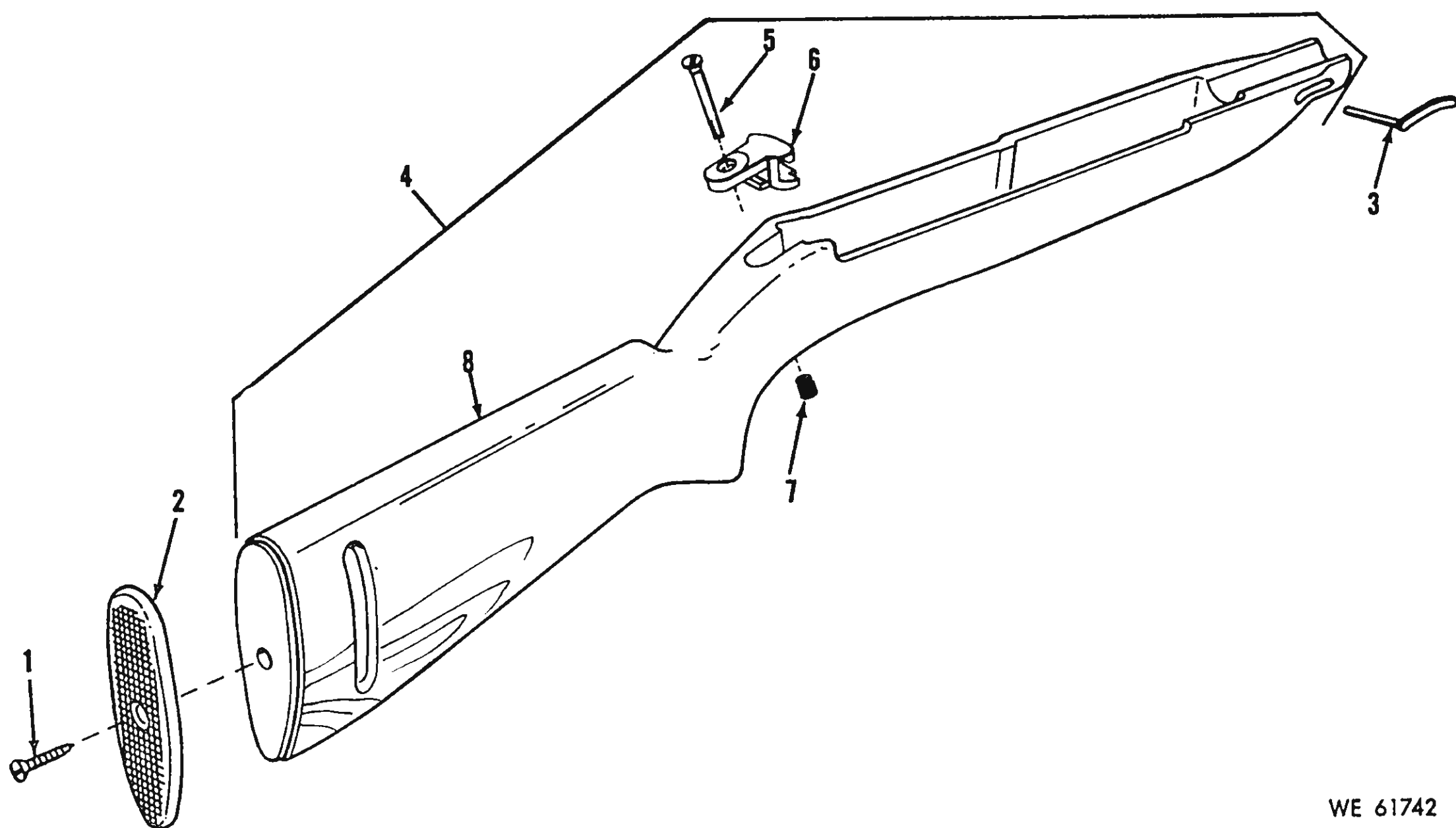

WE 61742

Figure B-2. Stock group—exploded view.

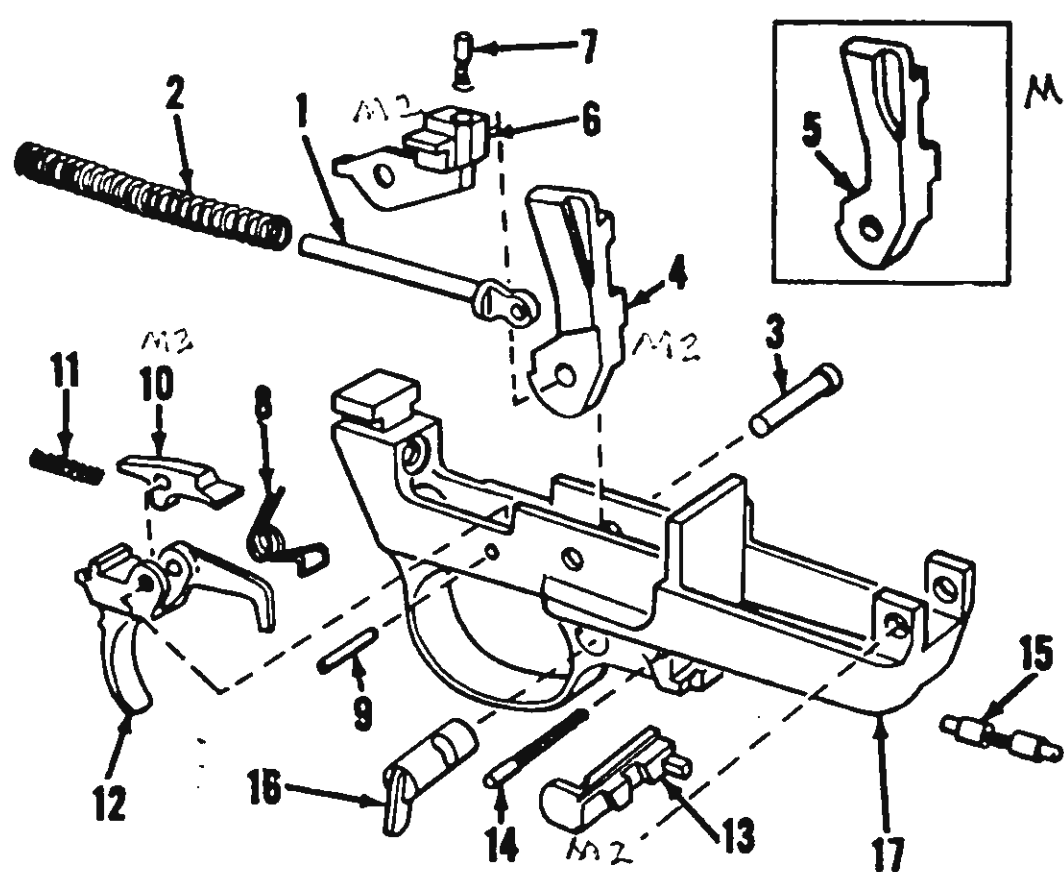

WE 61743

Figure B-3. Trigger housing assembly—exploded view.

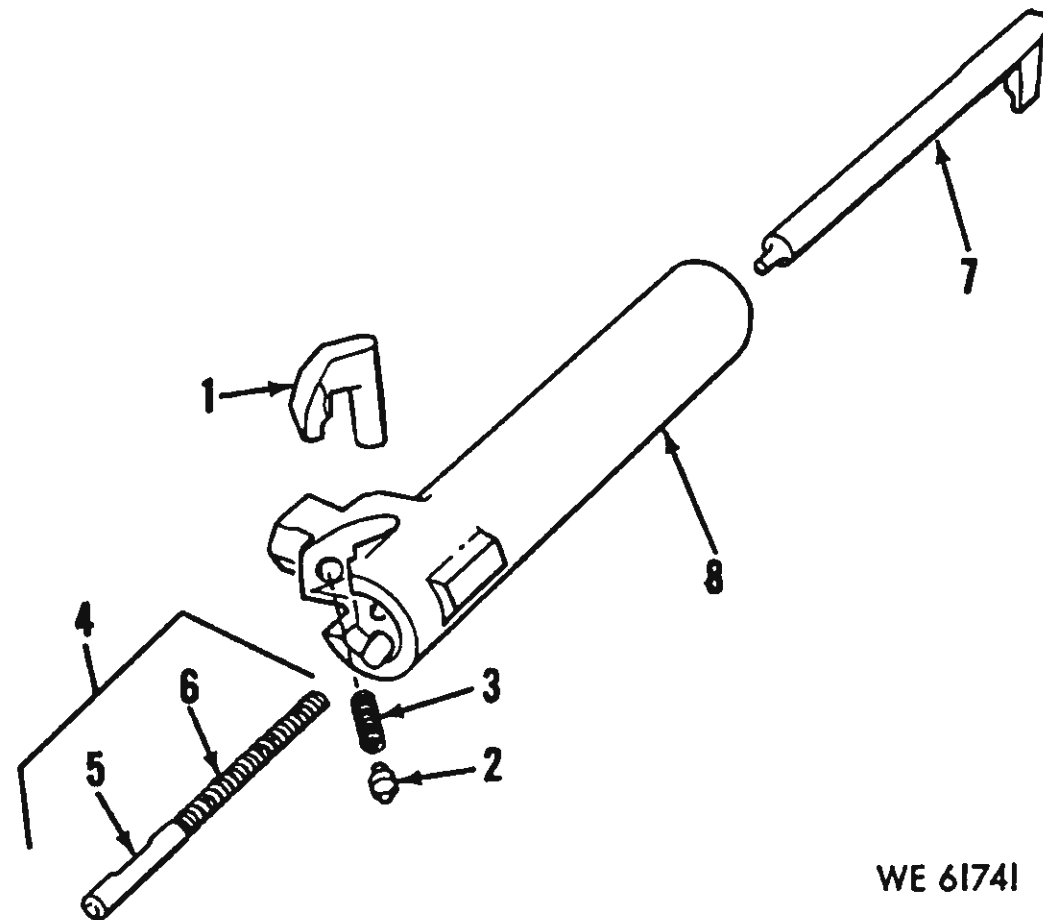

WE 61741

Figure B-4. Bolt assembly—exploded view.

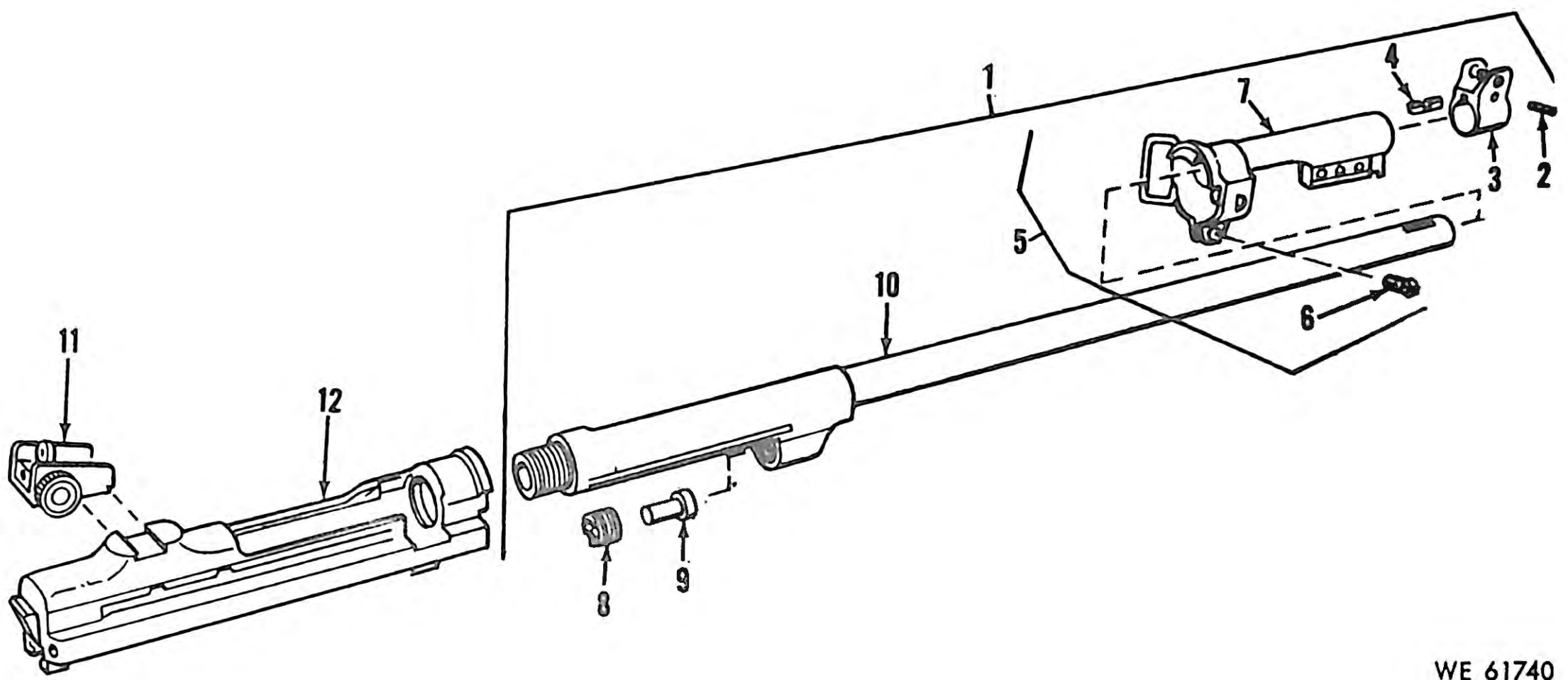

WE 61740

Figure B-5. Barrel and receiver group—exploded view.

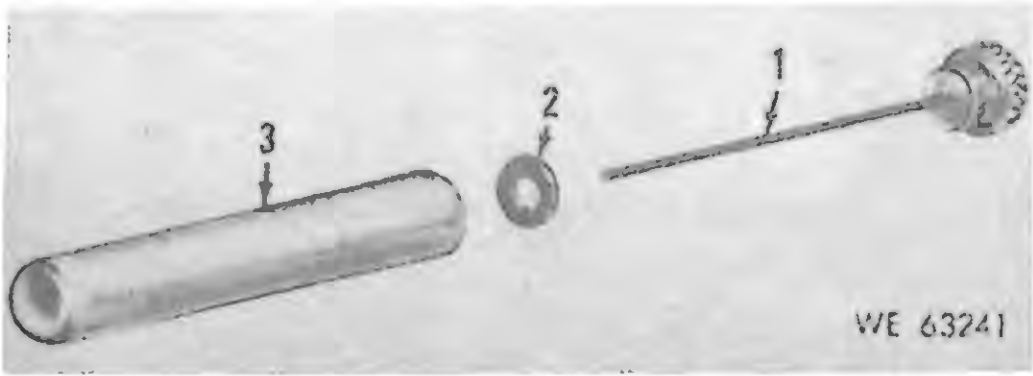
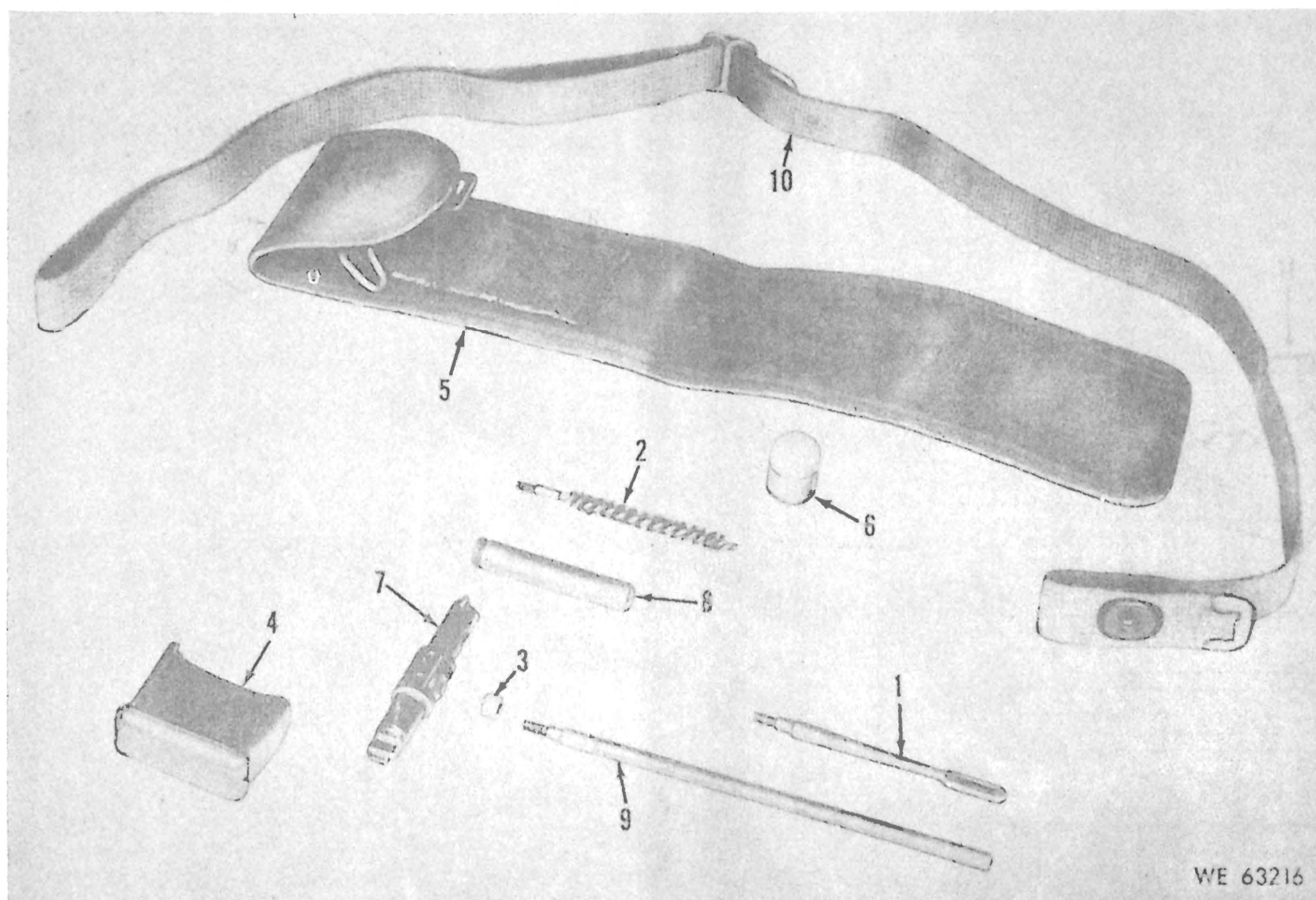
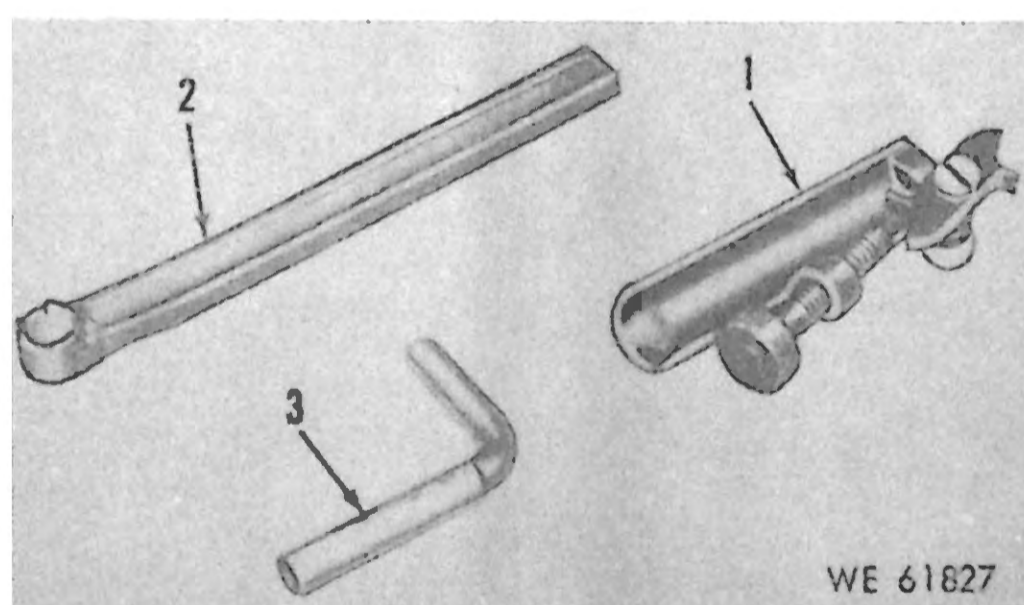

Figure B-6. Oiler—exploded view.



WE 63216

Figure B-7. Tools and equipment.



WE 61827

Figure B-8. Tools and equipment.

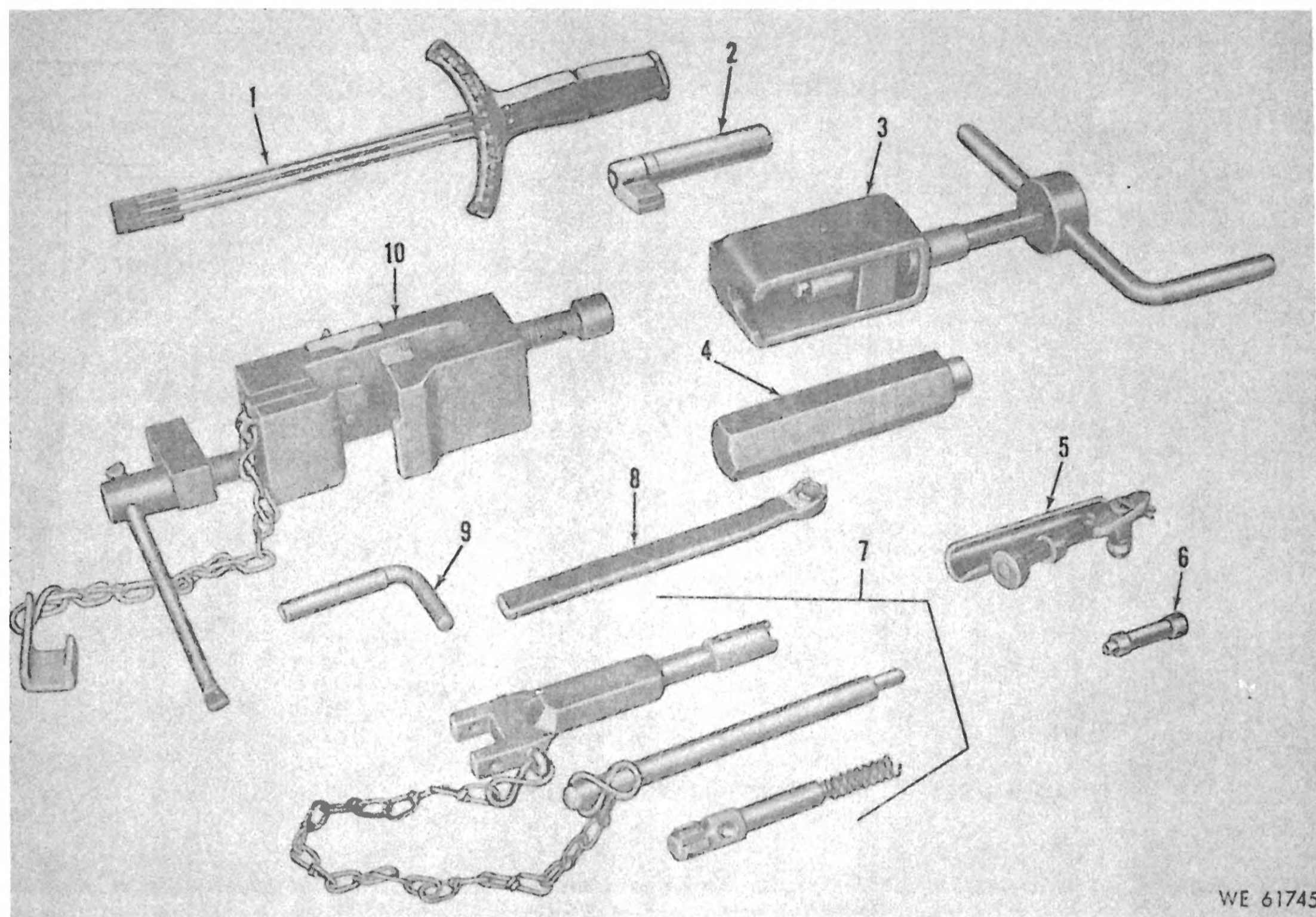

Figure B-9. Tools and equipment.

Section IV. FEDERAL STOCK NUMBER AND REFERENCE NUMBER
CROSS-REFERENCE TO FIGURE AND ITEM NUMBER

Stock Number	Fig. No.	Item No.	Stock Number	Fig. No.	Item No.	Stock Number	Fig. No.	Item No.
1005-313-9442	B4	3	1005-620-0995	B5	3	1005-726-6110	B7	1
1005-519-6436	B5	8	1005-620-0997	B2	2	1005-731-2452	B1	13
1005-519-6437	B4	2	1005-614-7695	B3	14	1005-731-2453	B1	14
1005-519-6446	B5	9	1005-621-2601	B4	4	1005-793-6761	B7	7
1005-519-6451	B5	4	1005-621-2602	B1	2	1005-928-6167	B2	8
1005-519-6456	B6	2	1005-657-3955	B5	11	4933-562-1065	B8	2
1005-519-6459	B3	8	1005-694-1662	B7	3		B9	8
1005-519-6462	B4	6	1005-716-0092	B4	8	4933-716-0026	B8	3
1005-519-6466	B1	5	1005-716-0472	B3	15		B9	9
1005-519-6484	B2	3	1005-716-0963	B5	5	4933-716-0995	B9	7
1005-537-7921	B3	2	1005-716-1828	B3	17	4933-716-1237	B9	3
1005-537-7984	B3	11	1005-716-1830	B1	8	4933-716-1313	B9	4
1005-550-6573	B7	5	1005-716-1837	B3	6	4933-731-2068	B9	10
1005-555-7150	B2	6	1005-716-1838	B1	7	4933-731-3298	B8	1
1005-555-7152	B7	10	1005-716-1839	B1	6		B9	5
1005-555-7154	B5	1	1005-716-1840	B3	4	4933-731-9932	B9	2
1005-556-4174	B7	2	1005-716-1841	B3	10	4933-731-9943	B9	6
1005-556-4364	B7	8	1005-716-1842	B3	13	5120-529-2552	B9	1
1005-565-3447	B3	5	1005-716-1843	B1	12	5305-299-1269	B5	6
1005-614-6873	B2	1	1005-716-1845	B2	4	5305-519-6442	B2	5
1005-620-0976	B4	7	1005-716-2080	B3	16	5310-519-6440	B2	7
1005-620-0981	B3	1	1005-716-2176	B1	1	5315-519-6449	B3	3
1005-620-0985	B1	4	1005-716-2546	B7	4	5315-519-6450	B1	10
1005-620-0987	B4	1	1005-716-2782	B3	7	5315-519-6453	B3	9
1005-620-0988	B3	12	1005-726-6109	B7	9	5315-519-6482	B5	2
						9150-248-3480	B7	6

Reference number	Mfg. Code	Figure No.	Item No.	Reference number	Mfg. Code	Figure No.	Item No.
GGG W 686	81348	B9	1	6212602	19205	B1	2
5196436	19205	B5	8	6544005	...	B1	11
5196437	19205	B4	2	6573955	19207	B5	11
5196440	19204	B2	7	7160004	19203	B5	6
5196442	19204	B2	5	7160026	19205	B8	3
5196446	19205	B5	9			B9	9
5196449	19204	B3	3	7160092	19205	B4	8
5196450	19204	B1	10	7160472	19205	B3	15
5196451	19205	B5	4	7160963	19205	B5	5
5196453	19204	B3	9	7160995	19205	B9	7
5196456	19205	B6	2	7161237	19205	B9	3
5196459	19205	B3	8	7161313	19205	B9	4
5196462	19205	B4	6	7161828	19205	B3	17
5196466	19205	B1	5	7161829	...	B1	9
5196480	...	B6	1	7161830	19204	B1	8
5196481	...	B6	3	7161837	19205	B3	6
5196482	19204	B5	2	7161838	19204	B1	7
5196484	19205	B2	3	7161839	19205	B1	6
5377921	19205	B3	2	7161840	19204	B3	4
5377984	19205	B3	11	7161841	19205	B3	10
5506573	19204	B7	5	7161842	19205	B3	13
5557150	19205	B2	6	7161843	19205	B1	12
5557152	19204	B7	10	7161844	19205	B2	8
5557154	19205	B5	1	7161845	19205	B2	4
5564174	19204	B7	2	7162080	19205	B3	16
5564364	19204	B7	8	7162176	19205	B1	1
5564365	...	B5	10	7162546	19204	B7	4
5621059	19204	B7	6	7162782	19205	B3	7
5653447	19204	B3	5	7162897	...	B1	15
5621065	19205	B8	2	7265615	...	B5	12
		B9	8	7266109	19205	B7	9
6146873	19205	B2	1	7266110	19204	B7	1
6147695	19205	B3	14	7266115	19204	B7	7
6200976	19204	B4	7	7267690	19205	B4	3
6200981	19205	B3	1	7268275	19204	B7	3
6200985	19205	B1	4	7312068	19205	B9	10
6200987	19205	B4	1	7312452	19205	B1	13
6200988	19205	B3	12	7312453	19205	B1	14
6200989	...	B4	5	7313298	19205	B8	1
6200995	19205	B5	3			B9	5
6200997	19205	B2	2	7319932	19205	B9	2
6212601	19205	B4	4	7319943	19205	B9	6

By Order of the Secretary of the Army:

W. C. WESTMORELAND,
General, United States Army,
Chief of Staff.

Official:

KENNETH G. WICKHAM,
Major General, United States Army,
The Adjutant General.

Distribution:

To be distributed in accordance with DA Form 12-40 (qty rqr Block #73), Direct and General Support requirements for Carbines, Cal. .30: M1 and M2.

☆ U. S. GOVERNMENT PRINTING OFFICE : 1973 O - 510-508 (7280A)

TM 9-1005-210-35 CARBINES, CAL. .30, M1 AND M2—1969